

NOTE
APPROVAL OF CONFIGURATION OF ACCESS
TO BE AS AUTHORIZED BY KNOX COUNTY
ENGINEERING & MPC STAFF.

PROJECT PHASING	
INITIAL DEVELOPMENT:	TEMPORARY OFFICE & STORAGE YARD ALL PARKING
PHASE 1:	OFFICE & SHOP (MARKED AS "PHASE 1" ON PLAN)
PHASE 2:	SHOP (MARKED AS "PHASE 2" ON PLAN)

NOTES	
1.	DRIVEWAY PROFILES TO MEET KNOX COUNTY STANDARDS.
2.	DETENTION AND WATER QUALITY REQUIREMENTS TO MEET KNOX COUNTY STANDARDS.

PARKING REQUIREMENTS	
INDUSTRIAL ESTABLISHMENT:	1 SPACE FOR EVERY 2 EMPLOYEES + VISITOR & CUSTOMER PARKING AS REQUIRED BY MPC
REQUIREMENTS:	24 EMPLOYEE PARKING SPACES + 10 VISITOR & CUSTOMER PARKING SPACES 34 PARKING SPACES
PROVIDED:	24 EMPLOYEE PARKING SPACES + 12 VISITOR & CUSTOMER PARKING SPACES 36 PARKING SPACES
** ALL FIGURES ABOVE EXCLUSIVE OF EQUIPMENT PARKING SPACES	

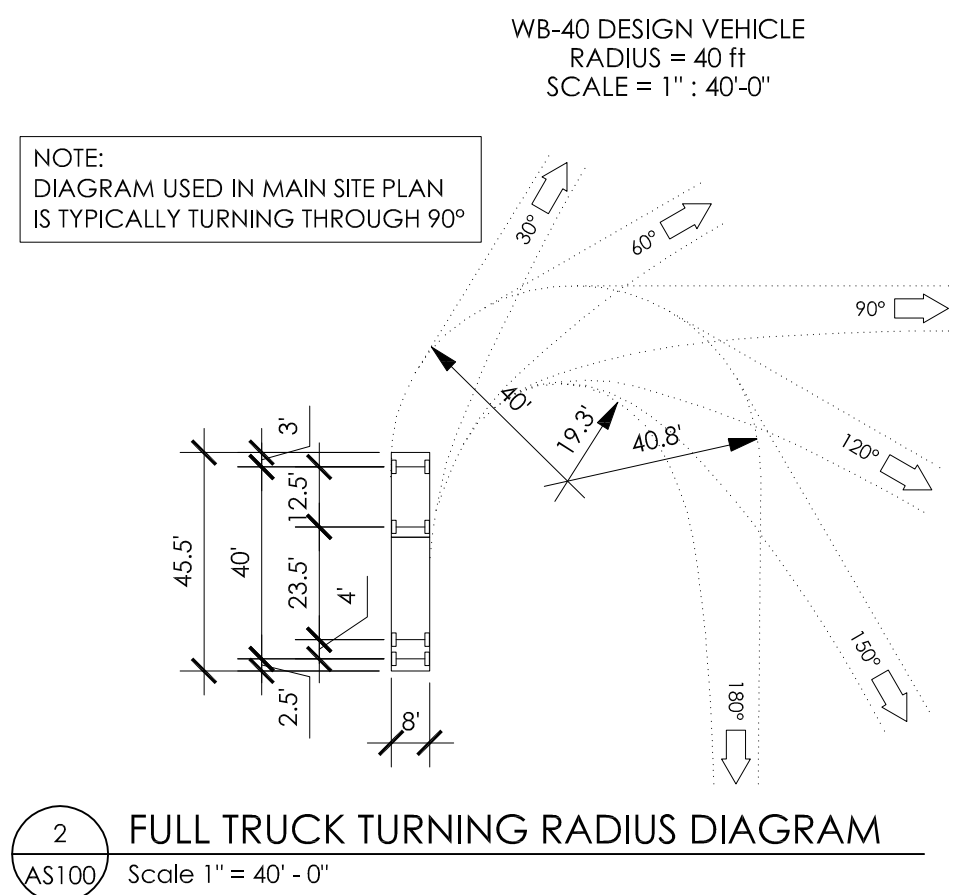

1
AS100
ARCHITECTURAL SITE PLAN
Scale 1" = 40' - 0"

12-E-17-UR
Revised: 11/27/2017

NEW DEVELOPMENT FOR
EAST TENNESSEE TREE SERVICE INC
OAK RIDGE HIGHWAY (HWY 62) & JIM JONES LANE
SOLWAY TENNESSEE

cope architecture
2607 Kingston Pike, Suite 5
Knoxville, Tennessee 37919
tel: 865.654.5000
www.copearchitecture.com

ARCHITECTURAL SITE PLAN

REVISIONS		
No.	Date	Description

The drawing is the property of
COPE ARCHITECTURE, INC. and is
not to be reproduced without
prior written authorization. This
drawing is intended to be used
only for the project and site
specifically identified. All design
information is the copyright of
COPE ARCHITECTURE, INC. © 2017

Date: 11/27/17

DESIGN DEVELOPMENT
PRELIMINARY FOR APPROVAL
NOT FOR CONSTRUCTION
REVIEW SUBMITTAL

Dwg No.
AS100
Project No. 17036