

OWNER: L.L. ENTERPRISES, LLC
1111 S. NORTHSHORE DRIVE
KNOXVILLE, TN 37934
865 414-9559

SITE ACREAGE: PHASE 1 1.99 ACRES
PHASE 2 1.38 ACRES
DISTURBED TOTAL 3.37 ACRES
PHASE 1 1.23 ACRES +/-
PHASE 2 1.0 ACRES +/-

ADDED IMPROVEMENTS 93,918 SQ. FT.

PROPERTY INFORMATION: 28221
CITY BLOCK NUMBER: 28221
PARCEL: 028.00
WARD: 28

VERTICAL DATUM: KGS NAVD83

PROPERTY BOUNDARIES, SITE DETAILS FROM SURVEY BY ROTH SURVEYING, 2014

GROUND TOPOGRAPHY WILL REPLACE KGS ONCE SURVEY IS COMPLETE.

SITE PLAN NOTES

HOURS OF OPERATION:
MONDAY - FRIDAY 8 AM - 6 PM
SATURDAY 8 AM - 3 PM
SUNDAY 10 AM - 5 PM
THANKSGIVING - FEB 28 8 AM - 5 PM
CHRISTMAS NEW YEAR'S DAY CLOSED

AREA BETWEEN NO FILL AND BUFFER WILL REMAIN UNDISTURBED. THIS AREA WILL CONTAIN AT LEAST 8 SWEET GUM AND OTHER WET TOLERATE, NATIVE SPECIES.

SANITARY SEWER EASEMENT IS MAINTAINED BY OTHERS.

ALL TREES RETAINED OR NEW SHALL BE PROPERLY MAINTAINED TO ENSURE THEIR SURVIVAL FOR 18 MONTHS AFTER DATE OF SUBSTANTIAL COMPLETION. ALL TREES SHALL BE REPLACED WITHIN 12 MONTHS OF LOSS.

GRAPHIC SCALE
(IN FEET)
1 inch = 30 ft.

SITE PLAN
SCALE: 1" = 30'-0"

GENERAL NOTES

GENERAL NOTES:
THE OWNER IS SOLELY RESPONSIBLE FOR ALL JOBSITE SAFETY, INCLUDING BUT NOT LIMITED TO COMPLIANCE WITH ANY APPLICABLE OSHA REGULATIONS.
ANY BUILDINGS SHOWN IN THE CIVIL PLANS ARE FOR GENERAL PURPOSES AND SHOULD NOT BE USED TO LAYOUT, CONFIRM FOUNDATIONS AND ELEVATIONS PRIOR TO CONSTRUCTION AND NOTIFY ENGINEER OF ANY DISCREPANCIES BEFORE START OF CONSTRUCTION.
CONFIRM LOCATIONS OF WATER LINES AND SANITARY SEWER LINES.
OWNER IS TO COORDINATE ALL SITE GRADING AND DRAINAGE WITH OWNER AND ENGINEER TO ENSURE PROPER SITE DRAINAGE.

- SITE KEYED NOTES
- 1 12' X 24' MODULAR OFFICE - \$46.00 MIN FEE OR EXISTING OVERSIDE BUILDING TO BE MOVED
 - 2 ACCESSIBILITY RAMP 1:12, 30' FT. MAX. RUN
 - 3 VAN ACCESSIBLE PARKING WITH ASSOCIATED
 - 4 EXISTING 10' ASPHALT DRIVE - REMOVE
 - 5 PROPOSED EVERGREEN LANDSCAPE
 - 6 BUFFER, 6 FT. HIGH MINIMUM
 - 10 LIGHT DUTY ASPHALT PAVING
 - 7 50' L X 20' W X 13.5' H MULCH STORAGE
 - 8 30' L X 10' W X 9' H MULCH STORAGE
 - 9 MIDNIGHT
 - 10 MOCHA
 - 11 FINE PINE
 - 12 CHOCOLATE CHIP
 - 13 TIP TOP SOIL
 - 14 PLAYGROUND

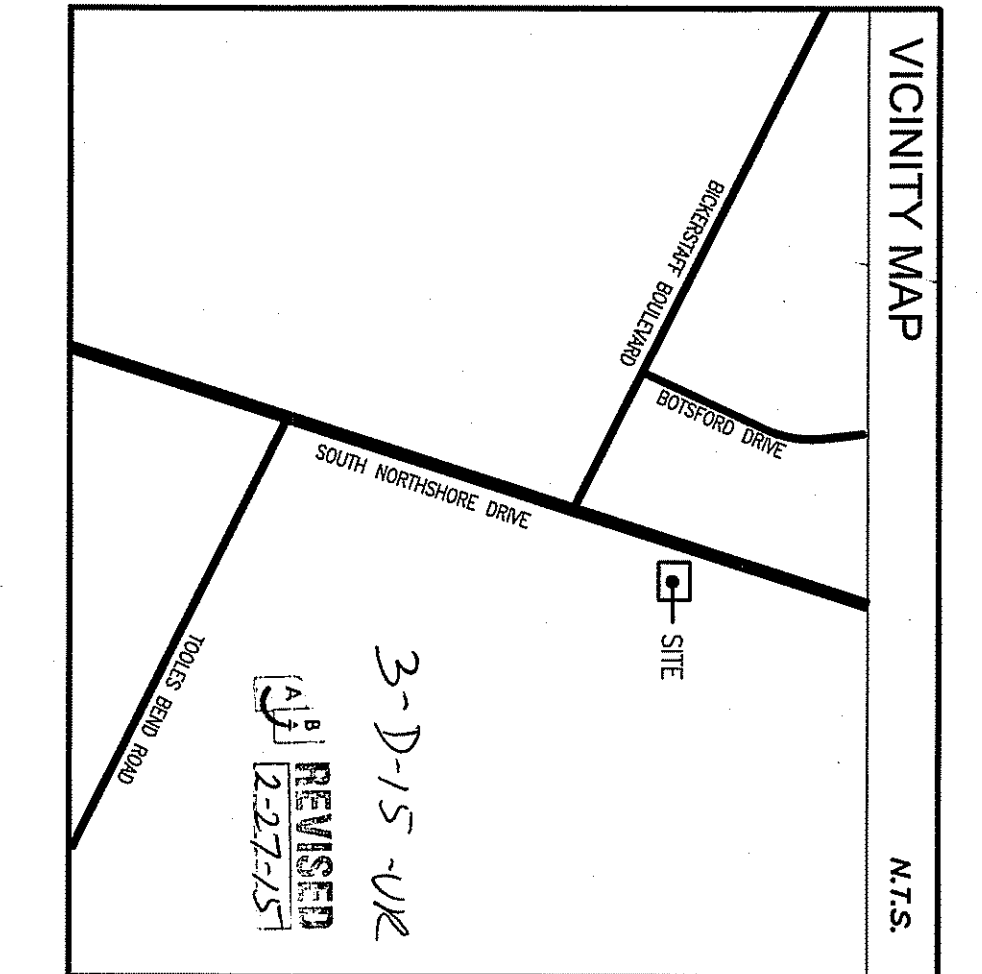

PROJECT: 15103

SHEET: 1 OF 2

DATE: 01/26/15

THE MULCH COMPANY
8718 SOUTH NORTHSHORE DRIVE
KNOXVILLE, TENNESSEE

SITE PLAN

NOT FOR CONSTRUCTION

MARK V GRAHAM
ENGINEERING CONSULTANTS, LLC
2/27/15

REVISIONS		DATE
NO.	DESCRIPTION	
1	MPC COMMENTS	02/27/15

MARK V GRAHAM
ENGINEERING CONSULTANTS, LLC

PO BOX 53131
KNOXVILLE, TN 37950

PHONE: 865 712-9210
MVG@MarkVGraham.com