

PARKING SPACES REQUIRED:
1 SPACE PER EMPLOYEE (ON THE LARGEST SHIFT) = 1 SPACE
CUSTOMER PARKING = 3 SPACES
TOTAL REQUIRED = 4 SPACES
TOTAL SHOWN = 4 SPACES (INCLUDES 1 HANDICAPPED SPACE)

GENERAL NOTES:

1. SITE INFORMATION PER KGIS.
2. PROPERTY INFORMATION:
CLT MAP 048EA, PARCEL 001
ZONING CA, CB & RB
AREA 10.2 ACRES
3. UTILITY AND DRAINAGE EASEMENT SHALL BE 10' INSIDE ROAD AND PROPERTY LINES.
FRONT SETBACK=20'
REAR SETBACK=16'
SIDE SETBACK=5'
4. NEW CONSTRUCTION MUST CONFORM TO ALL LOCAL ZONING REGULATIONS.
5. A PROPOSED FENCE WILL BE PLACED TWO FEET OFF OF THE PROPOSED CURB UNLESS OTHERWISE NOTED.
6. A 50' MINIMUM WIDTH BUFFER SHALL BE PROVIDED ON EACH SIDE OF STREAM. THE BUFFER SHALL CONSIST OF AN UNDISTURBED 25' INNER ZONE AND A VEGETATED 25' OUTER ZONE.
7. PRIOR TO COMMENCEMENT OF WORK, CONTRACTOR SHALL VERIFY SITE CONDITIONS, DIMENSIONS, ELEVATIONS, AND LOCATION OF EXISTING FEATURES AFFECTED BY WORK. CONTRACTOR SHALL NOTIFY THE ENGINEER OF ANY INTERFERENCES OR DISCREPANCIES BEFORE PROCEEDING WITH THE WORK. CONTRACTOR SHALL INSTALL EROSION CONTROL MEASURES PRIOR TO ANY LAND-DISTURBING ACTIVITY. EROSION AND SEDIMENT CONTROL BEST MANAGEMENT PRACTICES SHALL BE MAINTAINED AT ALL TIMES THROUGHOUT CONSTRUCTION AND UNTIL PERMANENT GROUND COVER HAS BEEN ESTABLISHED ON ALL DISTURBED AREAS.
9. CONTRACTOR SHALL INSPECT SEDIMENT CONTROL MEASURES AT LEAST TWICE WEEKLY (72 HOURS APART).
10. APPLY TEMPORARY SEEDING WHENEVER GRADING OPERATIONS ARE TEMPORARILY HALTED FOR OVER 14 DAYS AND FINAL GRADING OF EXPOSED SURFACES ARE TO BE COMPLETED WITHIN ONE YEAR. APPLY TEMPORARY SEEDING TO SOIL STOCKPILES.
11. APPLY PERMANENT SEEDING WHENEVER GRADING OPERATIONS ARE COMPLETED AND ALL CONSTRUCTION OPERATIONS WILL NOT IMPACT THE DISTURBED AREA. APPLY PERMANENT SEEDING TO ALL NON-CONSTRUCTION AREAS THAT SHOW SIGNS OF EXCESSIVE EROSION.
12. EXISTING CURB OPENING TO BE CLOSED. NEW DRIVEWAY WILL REQUIRE TDOT AND CITY OF KNOXVILLE ENTRANCE PERMIT.
13. EXISTING SEDIMENT BASIN SHALL BE BACKFILLED WITH ENGINEERING FILL TO PROPOSED GRADE. INSTALL 2'-6" GABION BASKET WALL AS NECESSARY TO MAINTAIN STREAM BUFFER.
14. STORMWATER FROM PROPOSED DEVELOPMENT WILL BE COLLECTED AND CONVEYED BENEATH EXISTING STREAM VIA BURIED DRAIN PIPE.
15. THIS IS A PRIORITY CONSTRUCTION SITE.

VICINITY MAP-NTS

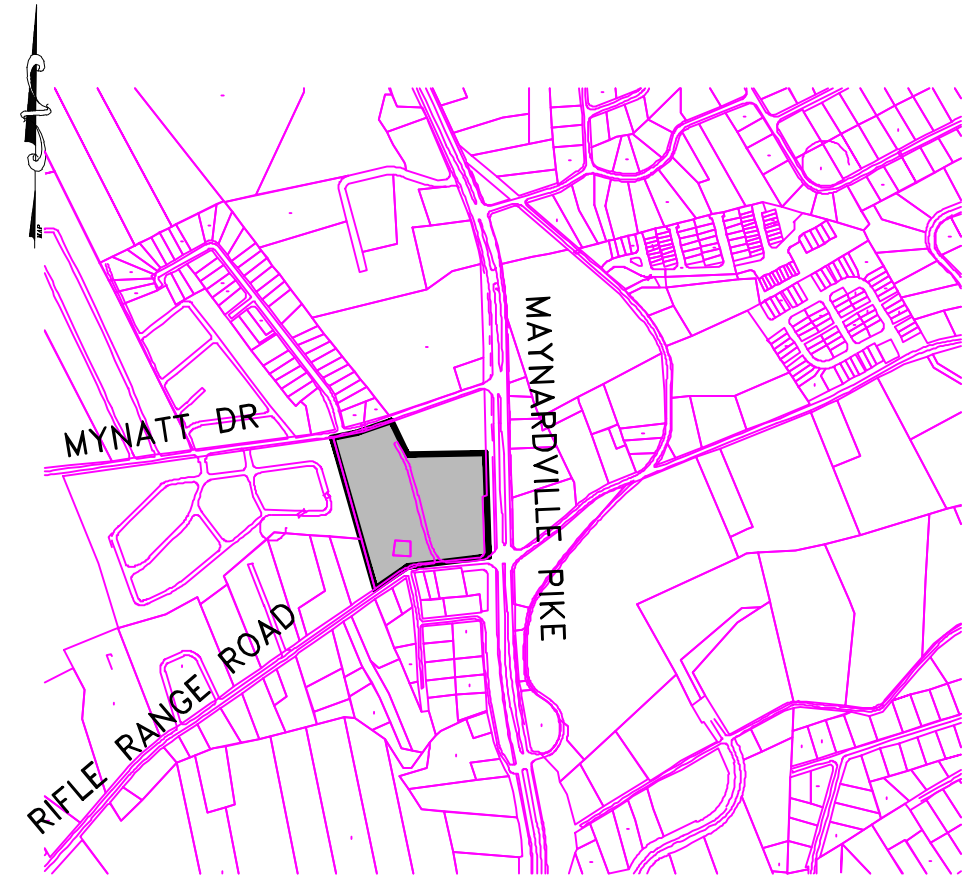

PVI STA=0+25
PVI ELEV=1104.2
A=-7.0
K=7.1
50' V.C.

PVI STA=0+75
PVI ELEV=1099.2
A=-3.6
K=13.9
50' V.C.

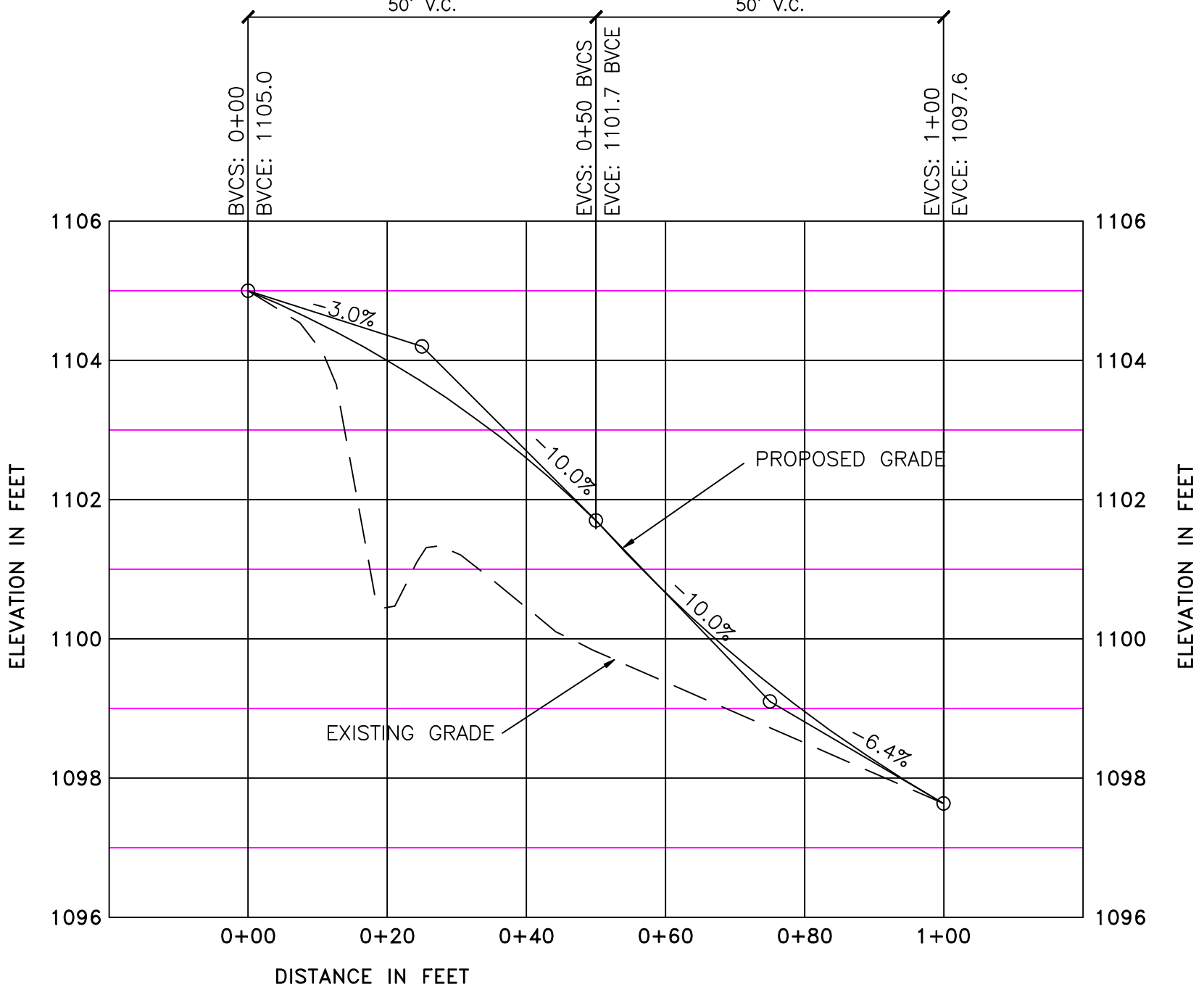

DRIVEWAY PROFILE
SCALE: 1"=20' HORIZ.
1"=2' VERT.

4-A-16-UR
Revised: 3/30/2016

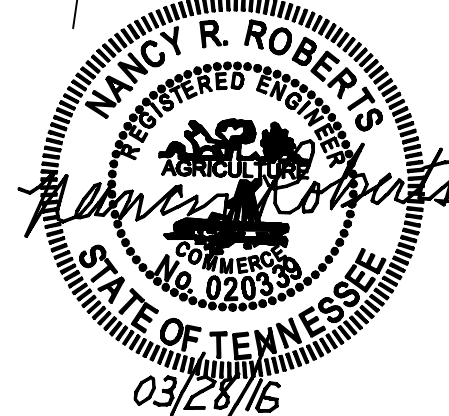

NOTE:
CONTRACTOR IS RESPONSIBLE FOR ALL TRENCH SAFETY
Contractor shall shore and brace all open cut trenches as required by State and Federal Laws and Local Ordinances, to conform with recommendations set forth in AGC Manual of Accident Prevention in Construction; to protect life, property, or work; to avoid excessively wide cuts in unstable material.
OSHA RULES SHALL BE ABIDED BY

SITE PLAN
SCALE: 1"=50'

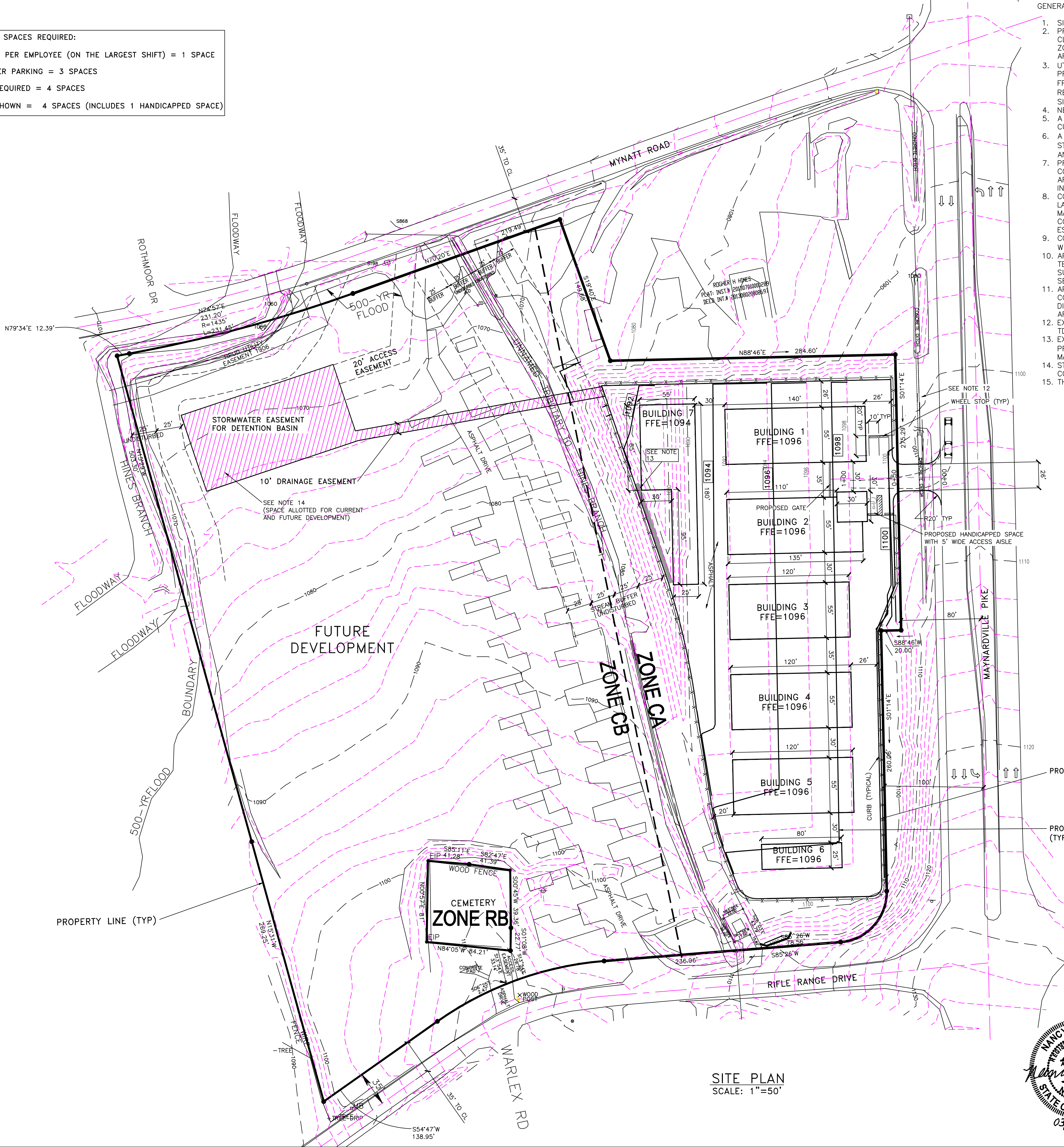

USE ON REVIEW PLAN AND DRIVEWAY PROFILE
SHEET C-1

StoreSafe Storage LLC
6417 Maynardville Pike
Knoxville, TN 37912

Prepared For:
Russ Amanns
StoreSafe Storage LLC
6165 Primus Road
Knoxville, Tennessee 37912
(865) 388-7362

LANDWATER ENGINEERING, INC.

LandWater Engineering
P.O. Box 52292
Knoxville, Tennessee 37950
(865) 599-1632

COPYRIGHT 2016