

CONTRACTOR SHALL REFER TO ARCHITECTURAL PLANS FOR EXACT LOCATIONS AND DIMENSIONS OF VESTIBULE, SLOPED PAVING, EXIT PORCHES, RAMPS, PRECISE BUILDING DIMENSIONS AND EXISTING BUILDING UTILITY LOCATIONS.	
<b>P A R K I N G     A N A L Y S I S</b>	
GROSS FLOOR AREA =	16,350 SF
STANDARD SPACES PROVIDED:	90 SPACES
HANDICAP SPACES PROVIDED:	4 SPACES
TOTAL SPACES PROVIDED:	94 SPACES
STALL DIMENSIONS:	10' x 20'
TOTAL IMPERVIOUS AREA ON SITE:	1.95 ACRES

<b>PERMANENT GRASSING SCHEDULE:</b>		<b>SITE PLAN NOTES:</b>	
GRASS SEED SHALL BE AS FOLLOWS FOR AREAS 34:1V OR LESS: FEB-NOV. .... TALL FESCUE (KY-31) 225 LB/ACRE ANNUAL RYE 25 LB/ACRE		1. ALL WORK AND MATERIALS SHALL COMPLY WITH REGULATIONS AND CODES AND O.S.H.A. STANDARDS.	
GROUND COVER SHALL BE AS FOLLOWS FOR SLOPES STEEPER THAN 34:1V: FEB-NOV. .... TALL FESCUE (KY-31) 175 LB/ACRE CROWN VETCH 15 LB/ACRE WELL ROOTED PLANT IN INDIVIDUAL GROWING CELLS OR SIMILAR CONTAINER W/ A MIN OF 2 RUNNERS NOT LESS THAN 8 INCHES LONG PLACED AT 12" O.C. 15 LB/ACRE		2. ALL DISTURBED AREAS NOT BUILT NOR PAVED UN TO RECEIVE FOUR INCHES OF TOPSOIL, SEED, MULCH, & D WATER UNTIL A HEALTHY STAND OF GRASS IS ESTABLISHED.	
ANNUAL RYE		3. ALL CURBED AND STRIPED RADII ARE TO BE 5' UNLESS OTHERWISE NOTED.	
SOD: ..... KENTUCKY-31		4. ALL DIMENSIONS AND RADII ARE TO FACE OF CURB UNLESS OTHERWISE NOTED.	
LIME: ..... 3 TONS/ACRE FERTILIZER: ..... 10/10/10 800-1000 LB/ACRE PHOSPHORUS: ..... 20% SUPERPHOSPHATE 500-800 LB/ACRE		5. BUILDING DIMENSIONS SHOWN ON SITE LAYOUT PLAN ARE NOMINAL DIMENSION ONLY INTENDED FOR USE IN DETERMINING APPROXIMATE SQUARE FOOTAGES. SEE ARCHITECTURAL PLANS FOR ACTUAL DIMENSIONS OF BUILDING CONSTRUCTION.	
MULCH: ..... STRAW 1-1/2 TONS/ACRE (CRIMPED) EROSION CONTROL NET OR MULCH BINDER ON SLOPES.		6. EXISTING STRUCTURES WITHIN THE CONSTRUCTION LIMITS ARE TO BE ABANDONED, REMOVED, OR RELOCATED AS NECESSARY. ALL COST SHALL BE INCLUDED IN BASE BID.	
MIN. SEED PURITY MIN. GERM. MAX. WEED TALL FESCUE ..... 90% 85% 0.1% ANNUAL RYE ..... 95% 90% 0.1% CROWN VETCH ..... 95% 90% 0.1%		7. CONTRACTOR SHALL BE RESPONSIBLE FOR ALL EROSION, INCLUDING BUT NOT LIMITED TO ALL UTILITIES, STORAGE, FENCING, ETC. AS REQUIRED. ALL WORK SHALL BE IN ACCORDANCE WITH GOVERNING AUTHORITIES SPECIFICATIONS AND SHALL BE APPROVED BY SUCH. ALL COST SHALL BE INCLUDED IN BASE BID.	
- PLANTING SHALL BE COMPLETE ON ALL AREAS NOT RECEIVE PAYING OR BE BUILT UPON WITHIN 14 WORKING DAYS OF COMPLETION OF GRADING. - ALL LIME & FERTILIZER AMOUNTS SHOWN IN THE PHOSPHORUS SECTION ABOVE ARE MINIMUM AND SHALL BE VERIFIED AFTER SOIL ANALYSIS IS ACCOMPLISHED. - ALL SEEDING SHALL BE BY GRADING CONTRACTOR. ALL SODDING SHALL BE BY LANDSCAPING CONTRACTOR.		8. SITE BOUNDARY , TOPOGRAPHY, UTILITY AND ROAD INFORMATION WAS TAKEN FROM A SURVEY BY SITE, INCORPORATE IN, DATED 02/05/09.	
<b>LEGEND:</b>		9. THE SITEWORK FOR THIS PROJECT SHALL MEET OR EXCEED "THE SITE WORK SPECIFICATIONS". ALL NECESSARY INSPECTIONS AND/OR CERTIFICATIONS REQUIRED BY CODES AND/OR UTILITY SERVICE COMPANIES SHALL BE PERFORMED PRIOR TO ANNOUNCED BUILDING POSSESSION AND THE FINAL CONNECTION OF SERVICES.	
PROPERTY LINE		10. BZA VARIANCE WILL BE REQUIRED FOR NUMBER OF PARKING SPACES.	
BUILDING SETBACK		11. VARIANCE WILL BE REQUESTED FOR RIGHT OF WAY ON E EMORY ROAD.	
18" CURB AND GUTTER		12. SITE DISTANCE ALONG E EMORY ROAD WILL MEET THE REQUIREMENTS.	
		13. ACCESS TO NORRIS FREEWAY IS SUBJECT TO CITY APPROVAL.	

IF YOU DIG TENNESSEE...  
CALL US FIRST!  
TENNESSEE ONE CALL SYSTEM, INC.  
IT'S THE LAW

GRAPHIC SCALE

50      0      25      50      100      200



( IN FEET )  
1 inch = 50 ft.

**STIE**  
**INCORPORATED**

Site Infrastructure Transportation Engineers  
Knoxville, TN 37932  
Fax: (865) 693-5668

2033 Coastric Lane, Suite 101  
Phone: (865) 693-5010

Site Layout Plan	 <p>Norris Freeway and Emory Road Knox County, Tennessee Aldi, Inc</p>
------------------	---

<i>DRAWN BY:</i>	atk	<i>DATE:</i>	03/24/09
<i>CHECKED BY:</i>	gcb	<i>FILE:</i>	1628-Layout
<b>REVISIONS</b>			
NO.	DATE	COMMENTS	

# C4.0



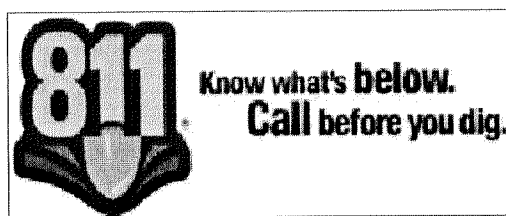
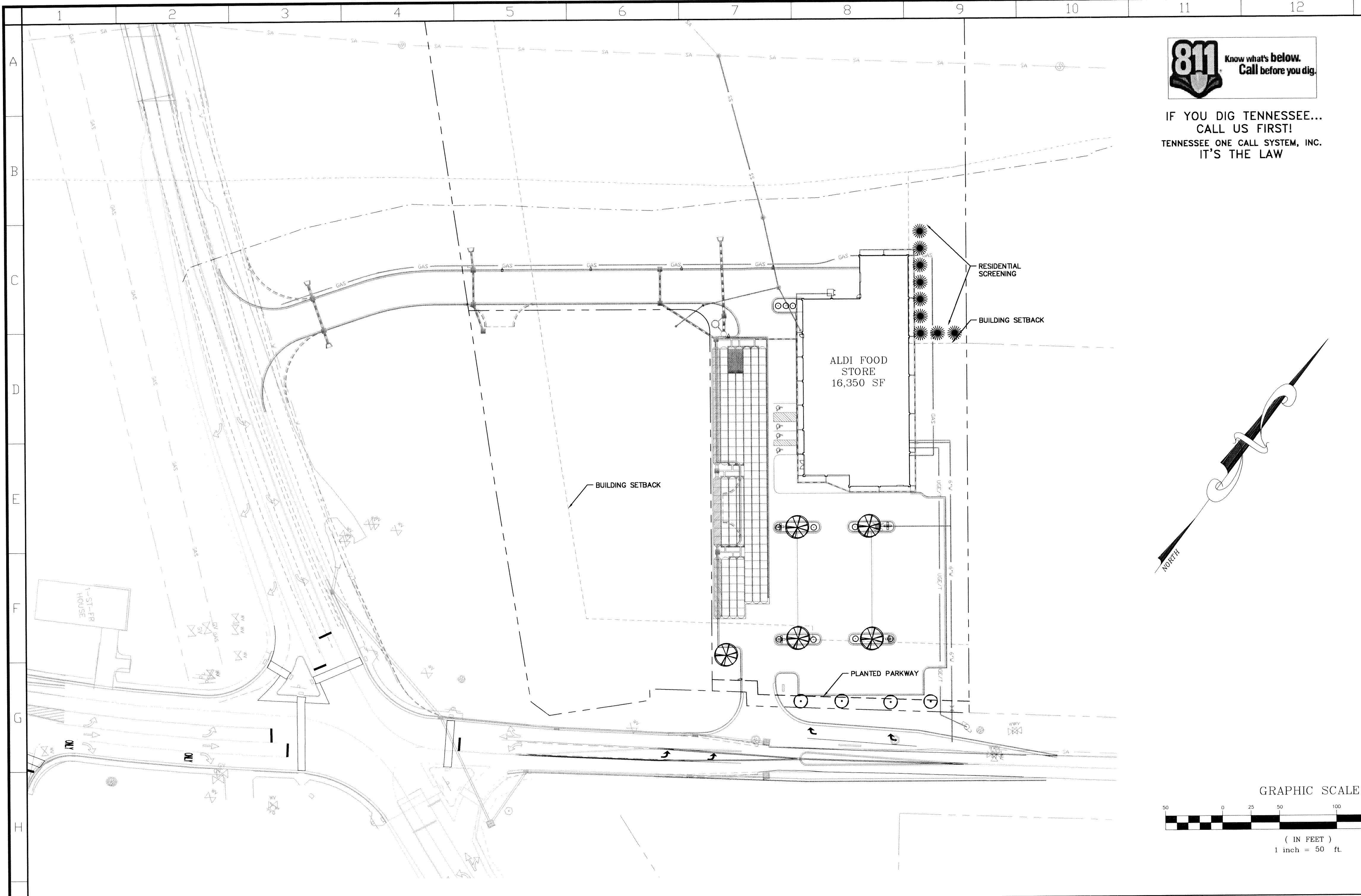

IF YOU DIG TENNESSEE...  
CALL US FIRST!  
TENNESSEE ONE CALL SYSTEM, INC.  
IT'S THE LAW

PLANT MATERIAL SCHEDULE					
Trees	Common Name	Botanical Name	Size	Qty.	Remarks
	Red Sunset Red Maple	Acer rubrum 'Red Sunset'	2" Caliper*	5	
	Eastern Redbud	Cercis canadensis	1 1/4" Caliper*	4	
	Loyland Cypress	xCypres:ocyparis Laylandii	5 FT Height	10	
	Otto Luken Laurel			9	
* Measured at 6" above ground.					

CAUTION - NOTICE TO CONTRACTOR

THE CONTRACTOR IS SPECIFICALLY CAUTIONED THAT THE LOCATION AND/OR ELEVATION OF EXISTING UTILITIES AS SHOWN ON THESE PLANS IS BASED ON RECORDS OF THE VARIOUS UTILITY COMPANIES AND, WHERE POSSIBLE, MEASUREMENTS TAKEN IN THE FIELD. THE INFORMATION IS NOT TO BE RELIED ON AS BEING EXACT OR COMPLETE. THE CONTRACTOR MUST CALL TENNESSEE ONE CALL AT LEAST 72 HOURS BEFORE ANY EXCAVATION TO REQUEST EXACT FIELD LOCATION OF UTILITIES. IT SHALL BE THE RESPONSIBILITY OF THE CONTRACTOR TO RELOCATE ALL EXISTING UTILITIES WHICH CONFLICT WITH THE PROPOSED IMPROVEMENTS SHOWN ON THE PLANS.

LANDSCAPE NOTES

- ALL PLANTS MUST BE HEALTHY, VIGOROUS MATERIAL, FREE OF PESTS AND DISEASE.
- ALL PLANTS MUST BE CONTAINER GROWN OR BALLED AND BURLAPPED AS INDICATED IN THE PLANT LIST.
- ALL TREES MUST BE STRAIGHT TRUNKED AND FULL HEADED AND MEET ALL REQUIREMENTS SPECIFIED.
- ALL PLANTS ARE SUBJECT TO THE APPROVAL OF THE OWNER'S DESIGNATED REPRESENTATIVE BEFORE, DURING, AND AFTER INSTALLATION.
- ALL TREES MUST BE GUYED OR STAKED AS SHOWN IN THE DETAILS.
- ALL PLANTING AREAS MUST BE COMPLETELY MULCHED WITH 4" HARDWOOD BARK MULCH AS SPECIFIED. PROVIDE A 4" DIAMETER RING OF MULCH AROUND ALL TREES IN GRASS AREAS. PREVENT MULCH FROM TOUCHING THE TRUNK OF THE TREE.
- PRIOR TO CONSTRUCTION, THE CONTRACTOR SHALL BE RESPONSIBLE FOR LOCATING ALL UNDERGROUND UTILITIES AND SHALL AVOID DAMAGE TO ALL UTILITIES AND SHALL AVOID DAMAGE TO ALL UTILITIES DURING THE COURSE OF THE WORK. THE CONTRACTOR IS RESPONSIBLE FOR REPAIRING ANY AND ALL DAMAGE TO UTILITIES, STRUCTURES, SITE APPURTENANCES, ETC., WHICH OCCUR AS A RESULT OF THE LANDSCAPE CONSTRUCTION.
- THE CONTRACTOR IS RESPONSIBLE FOR VERIFYING ALL QUANTITIES SHOWN ON THESE PLANS BEFORE PRICING THE WORK.
- THE CONTRACTOR IS RESPONSIBLE FOR FULLY MAINTAINING ALL PLANTING (INCLUDING BUT NOT LIMITED TO WATERING, SPRAYING, MULCHING, FERTILIZING, ETC.) OF THE PLANTING AREAS AND LAWN UNTIL THE WORK IS ACCEPTED IN TOTAL BY THE OWNER.
- THE CONTRACTOR SHALL COMPLETELY GUARANTEE ALL PLANT MATERIAL FOR A PERIOD OF ONE (1) YEAR BEGINNING ON THE DATE OF TOTAL ACCEPTANCE. THE CONTRACTOR SHALL PROMPTLY MAKE ALL REPLACEMENTS BEFORE OR AT THE END OF THE GUARANTEE PERIOD.
- AFTER BEING DUG AT THE NURSERY SOURCE, ALL TREES IN LEAF SHALL BE ACCLIMATED FOR TWO (2) WEEKS UNDER A MIST SYSTEM PRIOR TO INSTALLATION.
- ANY PLANT MATERIAL WHICH DIES, TURNS BROWN, OR DEFOLIATES PRIOR TO TOTAL ACCEPTANCE OF THE WORK SHALL BE PROMPTLY REMOVED FROM THE SITE AND REPLACED WITH MATERIAL OF THE SAME SPECIES, QUANTITY, AND SIZE AND MEETING ALL PLANT LIST SPECIFICATIONS.
- STANDARDS SET FORTH IN "AMERICAN STANDARD FOR NURSERY STOCK" REPRESENT GUIDELINE SPECIFICATIONS ONLY AND SHALL CONSTITUTE MINIMUM QUALITY REQUIREMENTS FOR PLANT MATERIAL.
- LOCATIONS OF EXISTING BURIED UTILITY LINES SHOWN ON THE PLANS ARE BASED UPON THE BEST AVAILABLE INFORMATION AND ARE TO BE CONSIDERED APPROXIMATE. IT SHALL BE THE RESPONSIBILITY OF THE CONTRACTOR TO VERIFY THE LOCATIONS OF UTILITY LINES ADJACENT TO THE WORK AREA. THE CONTRACTOR IS RESPONSIBLE FOR THE PROTECTION OF ALL UTILITY LINES DURING THE CONSTRUCTION PERIOD.
- SAFE, CLEARLY MARKED PEDESTRIAN AND VEHICULAR ACCESS TO ALL ADJACENT PROPERTIES MUST BE MAINTAINED THROUGHOUT THE CONSTRUCTION PROCESS.
- ALL PLANT MATERIAL QUANTITIES SHOWN ARE APPROXIMATE. CONTRACTOR SHALL BE RESPONSIBLE FOR COMPLETE COVERAGE OF ALL PLANTING BEDS AT SPACING SHOWN.
- ALL DISTURBED AREAS TO BE SEEDED ARE TO RECEIVE 4" OF TOP SOIL, MULCH, AND WATER UNTIL A HEALTHY STAND OF GRASS IS OBTAINED. THIS IS EXCLUDING ALL LANDSCAPED ISLANDS AND ENTRANCE AREAS.
- REFER TO WAL-MART SPECIFICATIONS FOR ALL INFORMATION NEEDED FOR IMPLEMENTATION OF PLANTING PLANS.

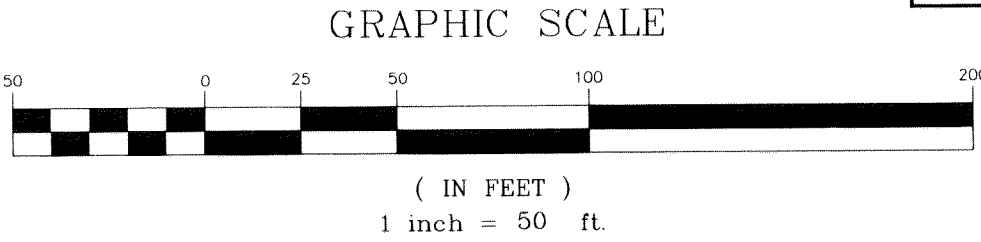

PERMANENT GRASSING SCHEDULE

GRASS SEED SHALL BE AS FOLLOWS FOR AREAS 3H:1V OR LESS:  
FEB - NOV. . . . . TALL FESCUE (KY-31) 225 LB/ACRE  
ANNUAL RYE 25 LB/ACRE  
GROUND COVER SHALL BE AS FOLLOWS FOR SLOPES STEEPER THAN 3H:1V:  
FEB - NOV. . . . . TALL FESCUE (KY-31) 175 LB/ACRE  
CROWN VETCH 25 LB/ACRE  
WELL ROOTED PLANT IN INDIVIDUAL GROWING CELLS OR SIMILAR CONTAINER W/ A MIN OF 2 RUNNERS NOT LESS THAN 6 INCHES LONG PLANTED AT 12" O.C. 15 LB/ACRE

ANNUAL RYE  
SOD . . . . . KENTUCKY-31  
LIME . . . . . 3 TONS/ACRE  
FERTILIZER . . . . . 10/10/10 800-1000 LB/ACRE  
PHOSPHORUS . . . . . 20% SUPERPHOSPHATE 500-800 LB/ACRE

MULCH	STRAW (CRIMPED) EROSION CONTROL NET OR MULCH BINDER ON SLOPES.
1-1/2 TONS/ACRE	
MIN. SEED PURITY	MIN. GERM. MAX. WEED
TALL FESCUE . . . . . 95%	85% 0.1%
ANNUAL RYE . . . . . 95%	90% 0.1%
CROWN VETCH . . . . . 95%	85% 0.1%

PLANTING SHALL BE COMPLETE ON ALL AREAS NOT RECEIVE PAVING OR BE BUILT UPON WITHIN 14 WORKING DAYS OF COMPLETION OF GRADING. ALL LIME & FERTILIZER AMOUNTS SHOWN IN THE PHOSPHORUS SECTION ABOVE ARE MINIMUM AND SHALL BE VERIFIED AFTER SOIL ANALYSIS IS ACCOMPLISHED. ALL SEEDING SHALL BE BY GRADING CONTRACTOR. ALL SODDING SHALL BE BY LANDSCAPING CONTRACTOR.

U.O.R.  
DATE  
REVISED  
3-25-09

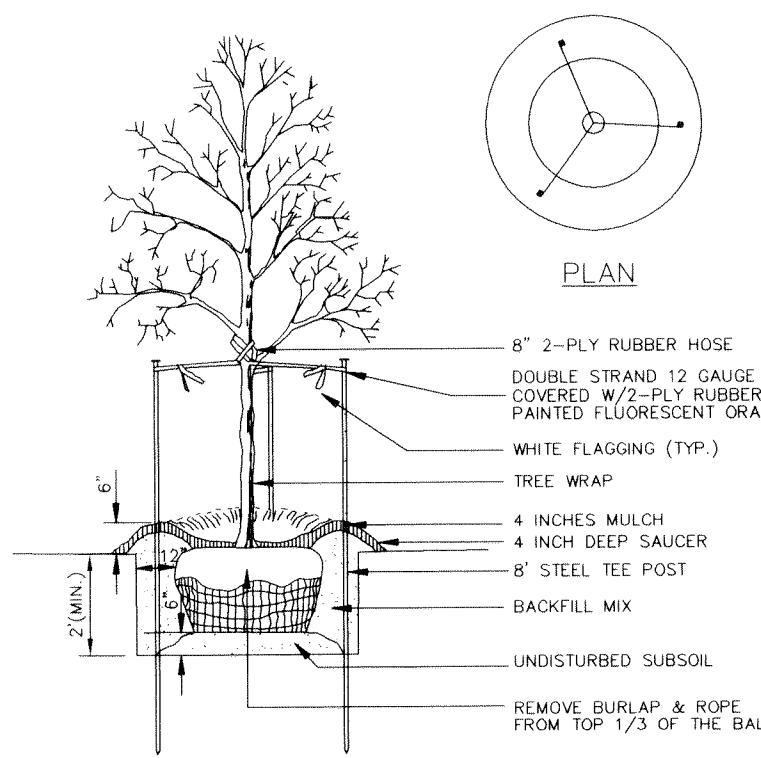

TREE PLANTING  
N.T.S.

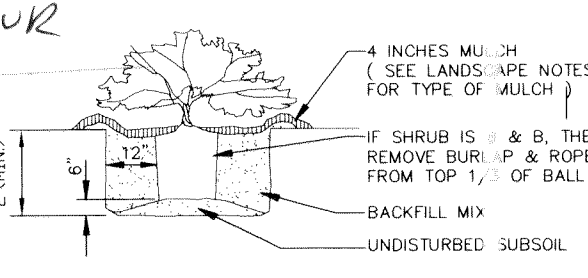

Shrub Planting  
N.T.S.

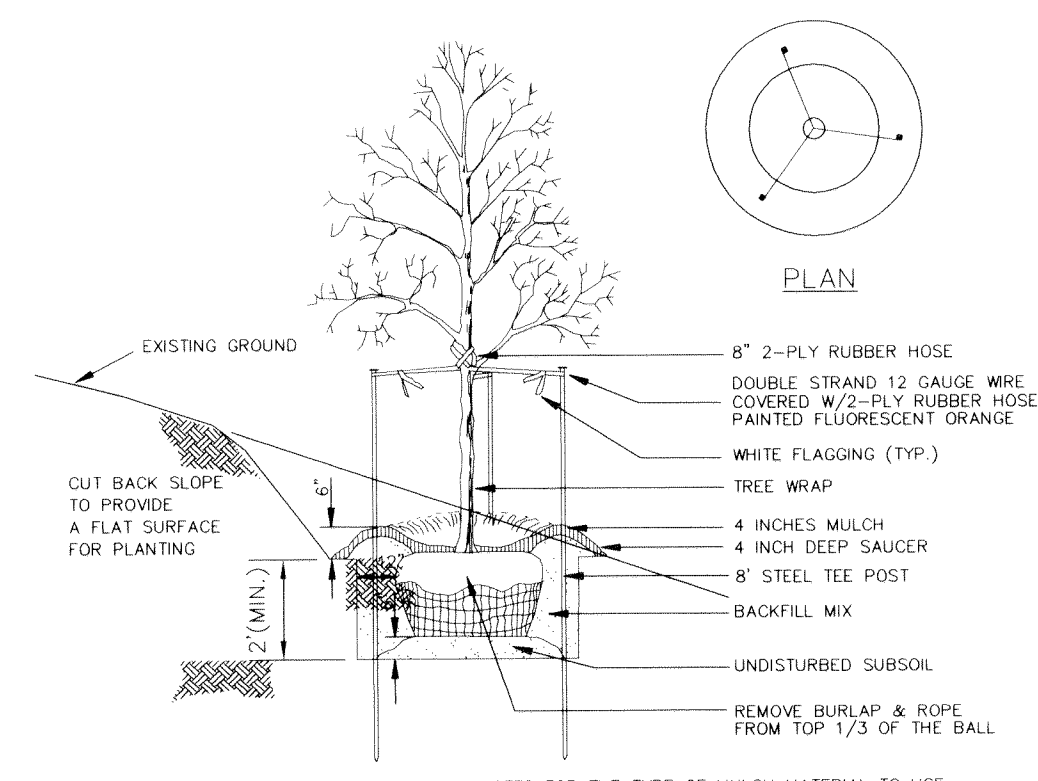

TREE PLANTING ON SLOPE  
N.T.S.

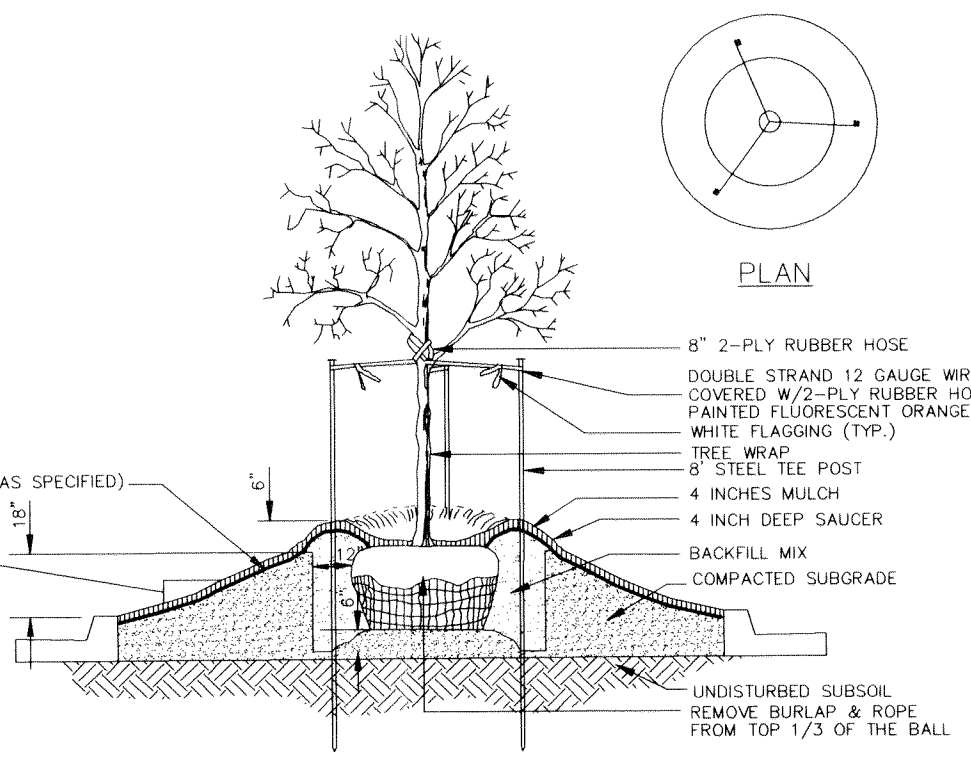

LANDSCAPE ISLAND  
N.T.S.

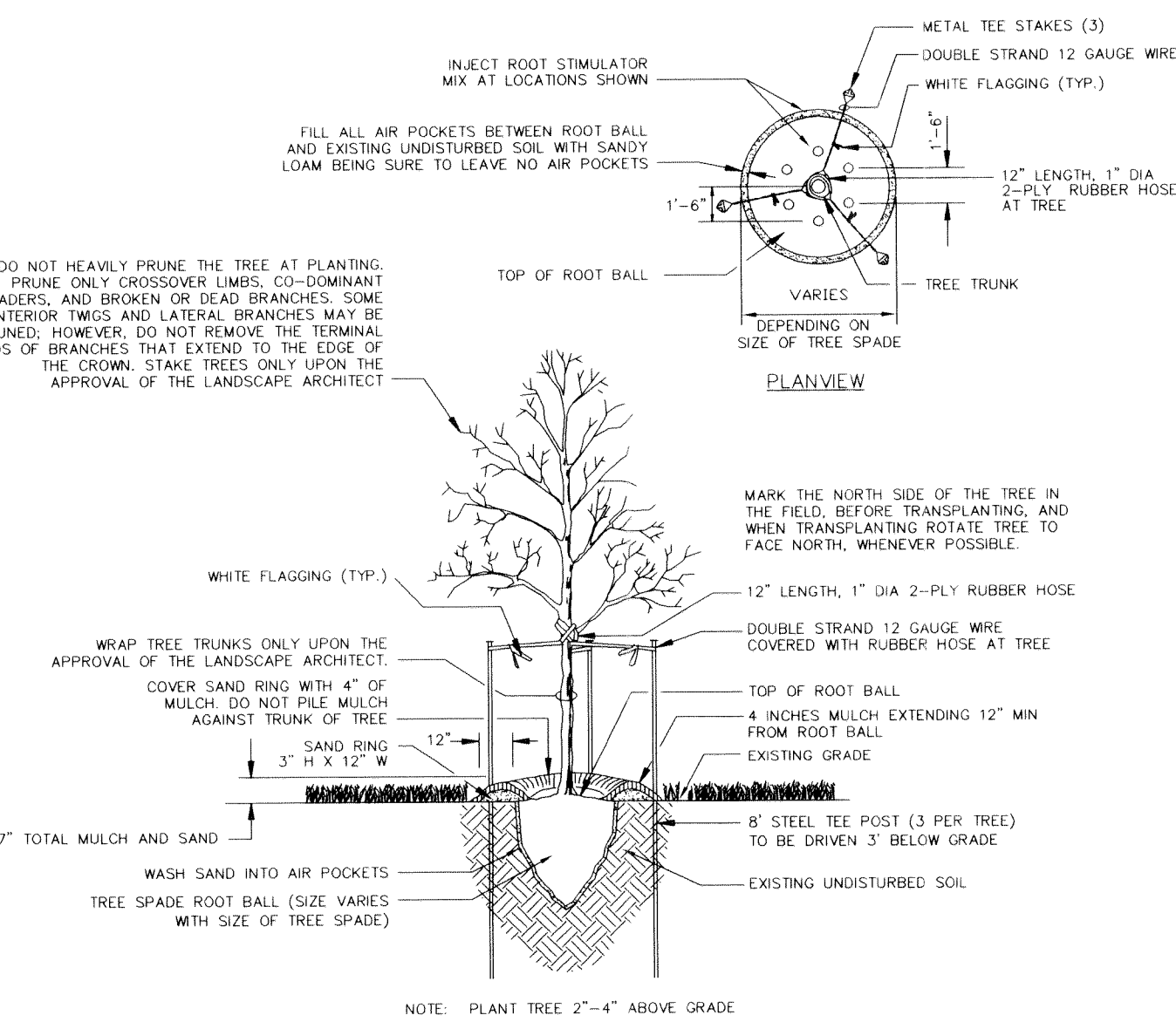

MACHINE DUG TREE PLANTING  
N.T.S.