

# CONCEPT PLAN/ USE ON REVIEW

## EDITH'S PLACE

0 MURRAY DRIVE, KNOXVILLE, TN  
DISTRICT NO. 6  
CITY BLOCK 40130

CLT: 068P GROUP C  
PARCEL: 015

ENGINEER:  
ROBERT G. CAMPBELL  
AND ASSOCIATES  
7523 TAGGART LANE  
KNOXVILLE, TN 37938  
PHONE: (865) 947-5996  
FAX: (865) 947-7556

DEVELOPER:  
TEKCO, LLC  
A.J. CANIZALES  
7412 OLD MAYNARDVILLE PIKE  
KNOXVILLE, TN 37938  
PHONE: (865) 388-1996

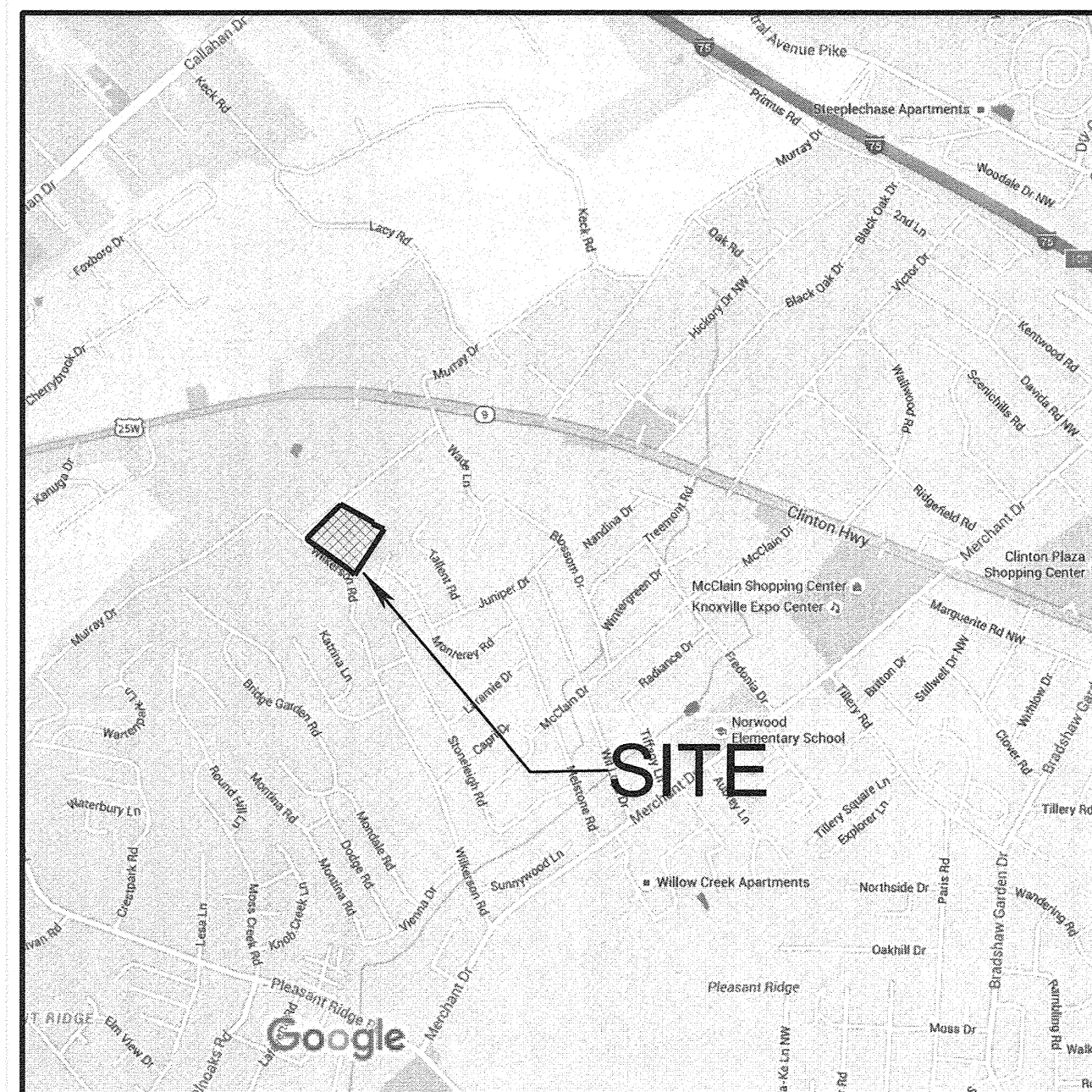

LOCATION MAP

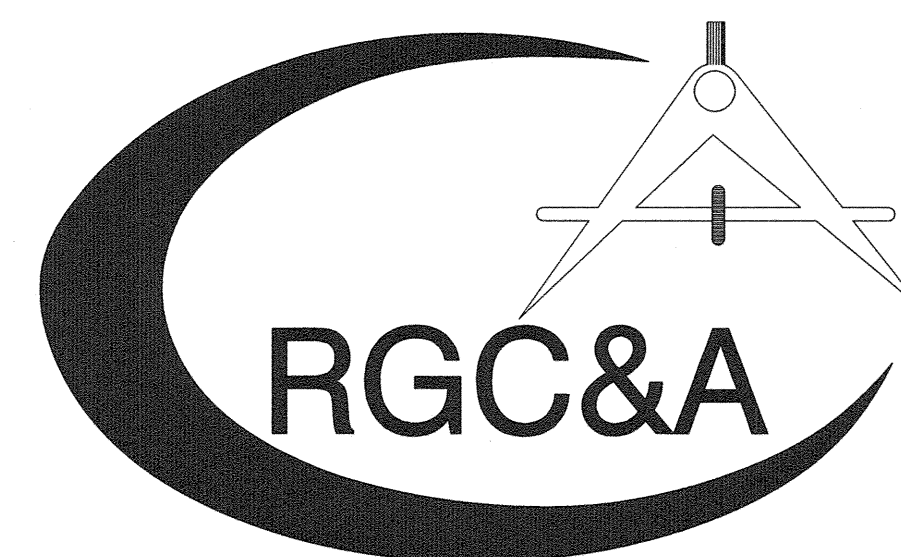

ROBERT G. CAMPBELL & ASSOCIATES , L.P.  
CONSULTING ENGINEERS  
KNOXVILLE , TENNESSEE

### CERTIFICATION OF CONCEPT PLAN

I HEREBY CERTIFY THAT I AM A SURVEYOR, LICENSED TO DO SURVEYING UNDER THE LAWS OF THE STATE OF TENNESSEE. I FURTHER CERTIFY THAT THE PLAN AND ACCOMPANYING DRAWINGS, DOCUMENTS AND STATEMENTS CONFORM TO ALL APPLICABLE PROVISIONS OF THE KNOXVILLE-KNOX COUNTY SUBDIVISION REGULATIONS EXCEPT AS HAS BEEN ITEMIZED AND DESCRIBED IN A REPORT WITH THE METROPOLITAN PLANNING COMMISSION.

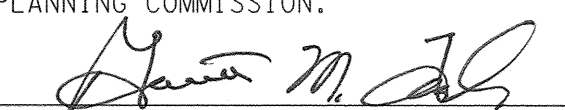
  
\_\_\_\_\_  
SURVEYOR

TENNESSEE CERTIFICATE NO. 1947

I HEREBY CERTIFY THAT SIGHT DISTANCE OF 300 FEET  
CAN BE ACHIEVED IN BOTH DIRECTIONS ALONG  
MURRAY DRIVE FROM THE PROPOSED ENTRANCE

  
\_\_\_\_\_

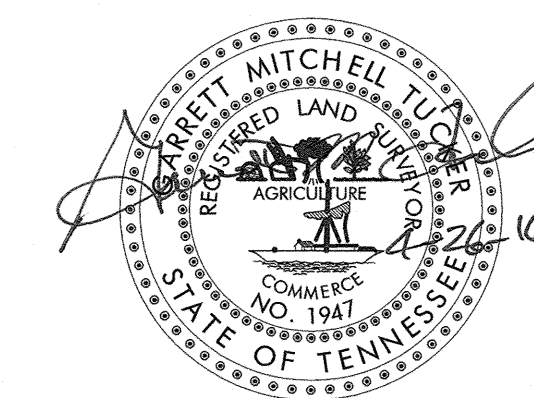

Revised: 4/27/2016

5-SC-16-C

5-F-16-UR



| CURVE DATA  |             |
|-------------|-------------|
| CURVE A-1   | CURVE B-1   |
| PI 10+62.83 | PI 22+45.09 |
| PC 10+48.98 | PC 22+27.57 |
| PT 10+76.51 | PT 23+00.73 |
| Δ 15°46'17" | Δ 99°12'41" |
| D 57°17'45" | D 57°17'45" |
| R 100.000   | R 100.000   |
| L 27.526    | L 173.156   |
| T 13.851    | T 117.523   |



PETTY HOLLIS C JR & BARBARA H  
1355 MURRAY DR

CHURCH STILL WATERS BAPTIST CHURCH  
1363 MURRAY DR

NOTE: 25' PERIPHERAL SETBACK APPLIES  
AROUND SUBDIVISION PERIMETER.  
30' PERIPHERAL SETBACK ON MURRAY  
DRIVE AND WILKERSON DRIVE.

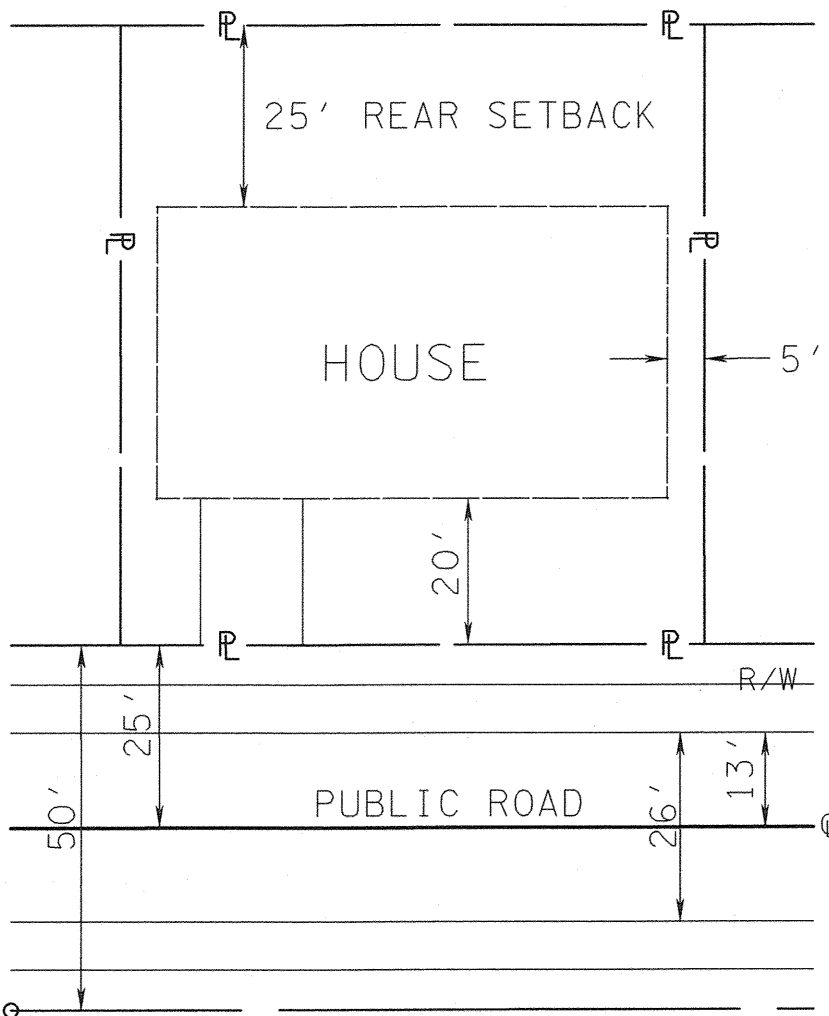

TYPICAL LOT LAYOUT  
(SINGLE FAMILY)

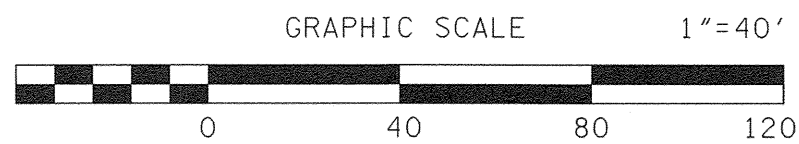

| NO.       | DATE | DESCRIPTION | BY | CHKD. |
|-----------|------|-------------|----|-------|
| REVISIONS |      |             |    |       |

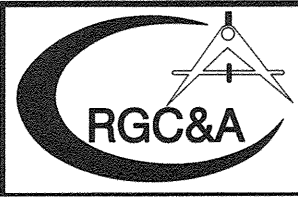

ROBERT G. CAMPBELL & ASSOC., L.P.  
CONSULTING ENGINEERS  
KNOXVILLE, TENNESSEE

EDITH'S PLACE  
CONCEPT PLAN / USE ON REVIEW

GENERAL LAYOUT  
PLAN VIEW

|                    |                   |                   |   |
|--------------------|-------------------|-------------------|---|
| DESIGNED BY<br>GMT | CHECKED BY<br>RGC | SCALE<br>1" = 40' | SHEET TWO<br>NO. <b>2</b><br>OF FIVE SHEETS |
| DRAWN BY<br>JER    | DATE<br>04/26/16  | FILE NO.<br>16016 |   |

- NOTES:
- EXCAVATE PERMANENT STORMWATER DETENTION POND IN ADVANCE OF CONSTRUCTION. AND USE AS SEDIMENT BASIN DURING CONSTRUCTION. REMOVE ACCUMULATED SEDIMENT AND INSTALL PERMANENT OUTLET STRUCTURE WHEN THE UPSTREAM DRAINAGE AREA IS STABILIZED.
  - SIGHT DISTANCE OF 300 FT IS AVAILABLE IN EACH DIRECTION ALONG MURRAY DRIVE.
  - EXISTING CONTOURS FROM KGIS.
  - LOCATIONS OF UNDERGROUND UTILITIES SHOWN ARE APPROXIMATE. THERE MAY BE OTHER UTILITIES NOT SHOWN. PRIOR TO ANY EXCAVATION, THE OWNER AND/OR CONTRACTOR IS RESPONSIBLE FOR CONTACTING THE LOCAL UTILITY AUTHORITIES FOR EXACT LOCATIONS AND DEPTHS.
  - CONTRACTOR IS RESPONSIBLE FOR ALL TRENCH SAFETY PRACTICES.
  - EROSION CONTROL MEASURES SHOWN ARE A MINIMUM. THE CONTRACTOR IS RESPONSIBLE FOR CONTROL OF EROSION FROM THE PROJECT SITE. ADDITIONAL ITEMS MAY BE REQUIRED.
  - a. APPLY TEMPORARY SEEDING WHENEVER GRADING OPERATIONS ARE TEMPORARILY HALTED FOR OVER 14 DAYS AND FINAL GRADING OF EXPOSED SURFACES IS TO BE COMPLETED WITHIN ONE YEAR. APPLY TEMPORARY SEEDING TO SOIL STOCKPILES.  
b. APPLY PERMANENT SEEDING WHENEVER GRADING OPERATIONS ARE COMPLETED AND ALL CONSTRUCTION OPERATIONS WILL NOT IMPACT THE DISTURBED AREA. APPLY PERMANENT SEEDING TO ALL NON-CONSTRUCTION AREAS WHICH SHOW SIGNS OF EXCESSIVE EROSION.
  - ACCESS TO ALL UNITS FROM INTERNAL ROAD SYSTEM ONLY.
  - A 15' SANITARY SEWER EASEMENT EXISTS ALONG SANITARY SEWER LINE, 7.5' EACH SIDE AS INSTALLED.
  - THE OWNER IS RESPONSIBLE FOR THE INSTALLATION AND MAINTENANCE OF CONSTRUCTION SITE POLLUTION PREVENTION CONTROLS THROUGHOUT THE LIFE OF THE PROJECT.

DEVELOPER:  
TEKCO, LLC  
A.J. CANIZALES  
7412 OLD MAYNARDVILLE PIKE  
KNOXVILLE, TN 37938  
PHONE: (865) 388-1996

ENGINEER:  
ROBERT G. CAMPBELL  
AND ASSOCIATES  
7523 TAGGART LANE  
KNOXVILLE, TN 37938  
PHONE: (865) 947-5996  
FAX: (865) 947-7556

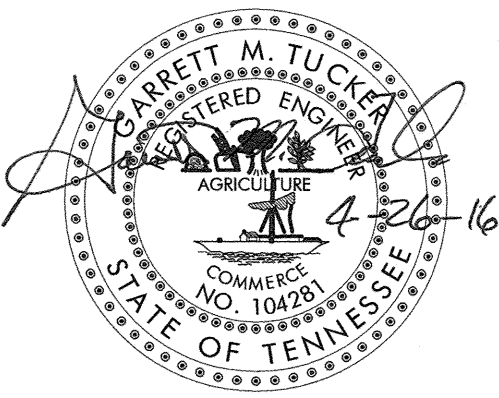

Revised: 4/27/2016

5-SC-16-C

5-F-16-UR

VARIANCES:

- REDUCE LENGTH OF VERTICAL CURVE ON ROAD "A" @ STA 10+60 FROM 150' TO 140'.
- REDUCE LENGTH OF VERTICAL CURVE ON ROAD B @ STA 20+50 FROM 105' TO 100'.
- INCREASE MAXIMUM GRADE OF ROAD A FROM 12% TO 13%.
- DECREASE MINIMUM RADIUS AT INTERSECTION OF ROAD A AND ROAD B FROM 75' TO 25'.

CLT MAP: 68P GROUP C  
PARCEL: 15  
DEED REFERENCE: 20130619-0083951  
TOTAL AREA: 6.46 ACRES  
NUMBER OF LOTS: 22  
PROPERTY ZONED: RP-1

MPC FILE NUMBER: 5-SC-15-C



5-F-16-UR

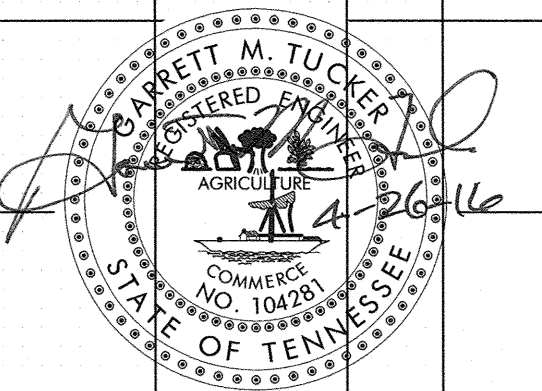
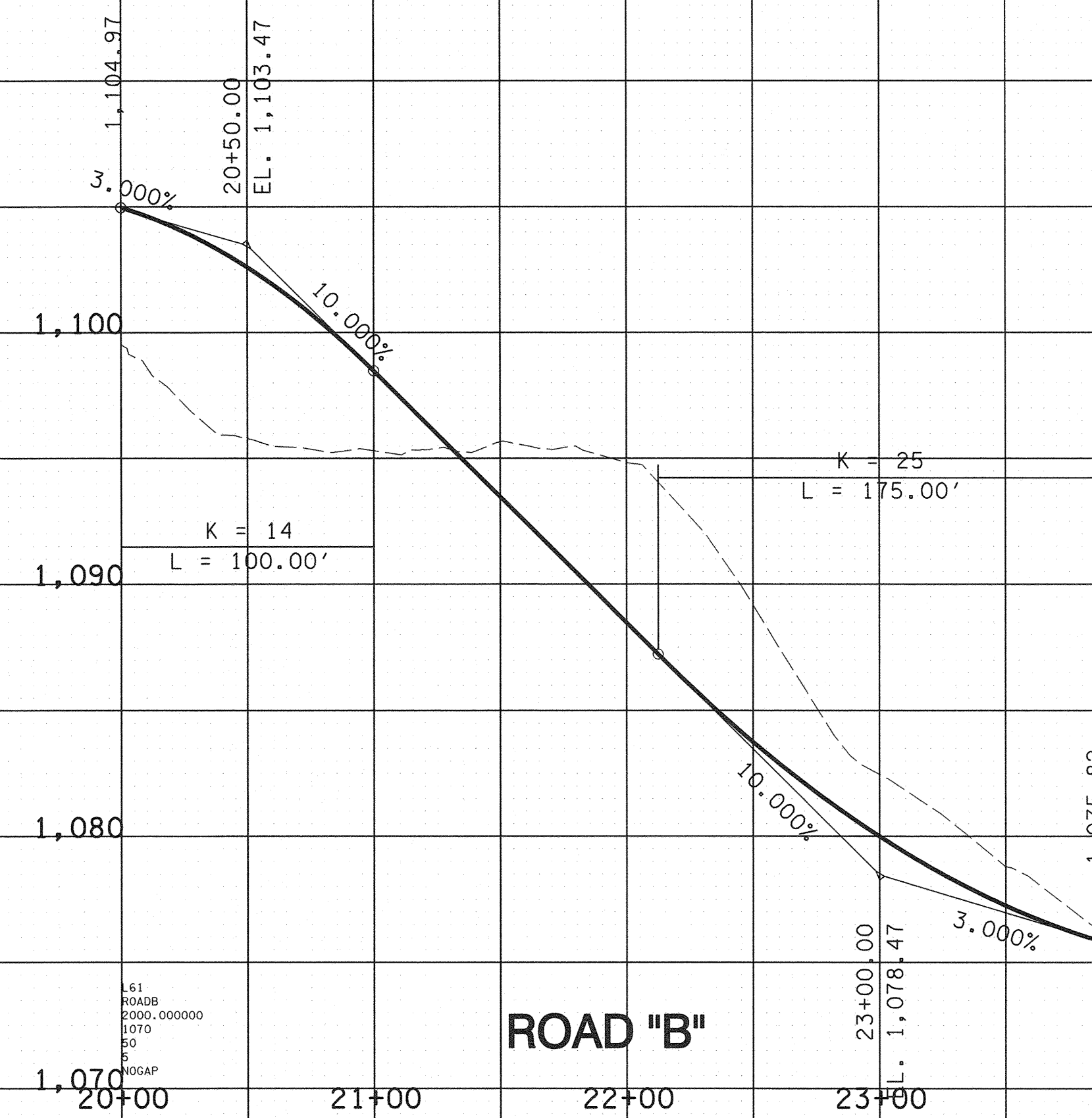
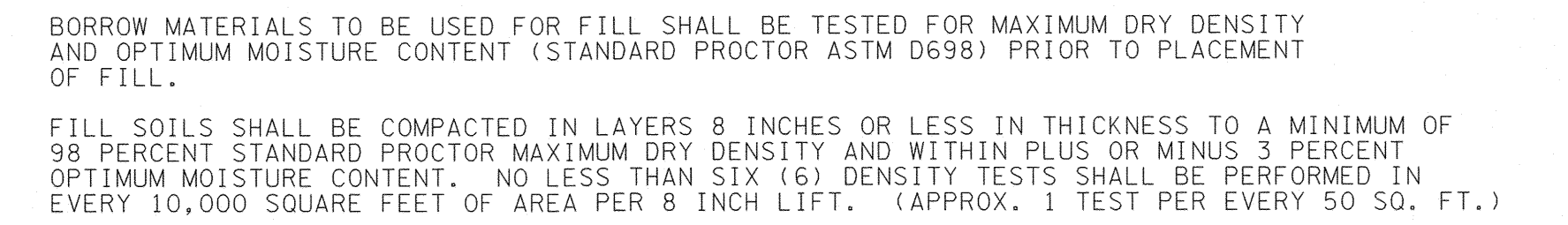

|           |      |             |     |      |
|-----------|------|-------------|-----|------|
| ___       | ___  | _____       | ___ | ___  |
| ___       | ___  | _____       | ___ | ___  |
| NO.       | DATE | DESCRIPTION | BY  | CKD. |
| REVISIONS |      |             |     |      |

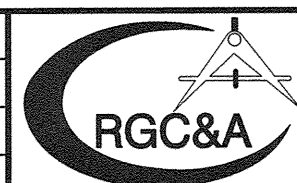

**EDITH'S PLACE**  
**CONCEPT PLAN / USE ON REVIEW**

|                           |                          |  |                             |
|---------------------------|--------------------------|--|-----------------------------|
| DESIGNED BY<br><b>GMT</b> | CHECKED BY<br><b>RGC</b> | SCALE<br><b>1"=50' HORZ.<br/>1"=5' VERT.</b> | SHEET THREE<br>NO. <b>3</b> |
| DRAWN BY<br><b>JER</b>    | DATE<br><b>04/26/16</b>  | FILE NO.<br><b>16016</b>                     | OF FIVE SHEETS              |



MAY ALSO BE CONSTRUCTED  
WITH SQUARE SHAPE

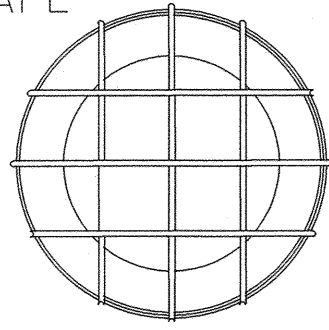

NOTE: TACK WELD ALL  
INTERSECTING BARS

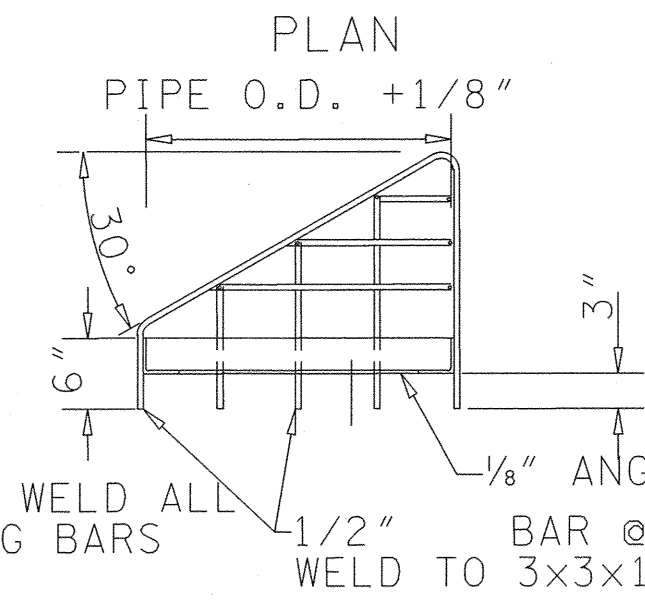

SECTION  
TRASH GRATE DETAIL

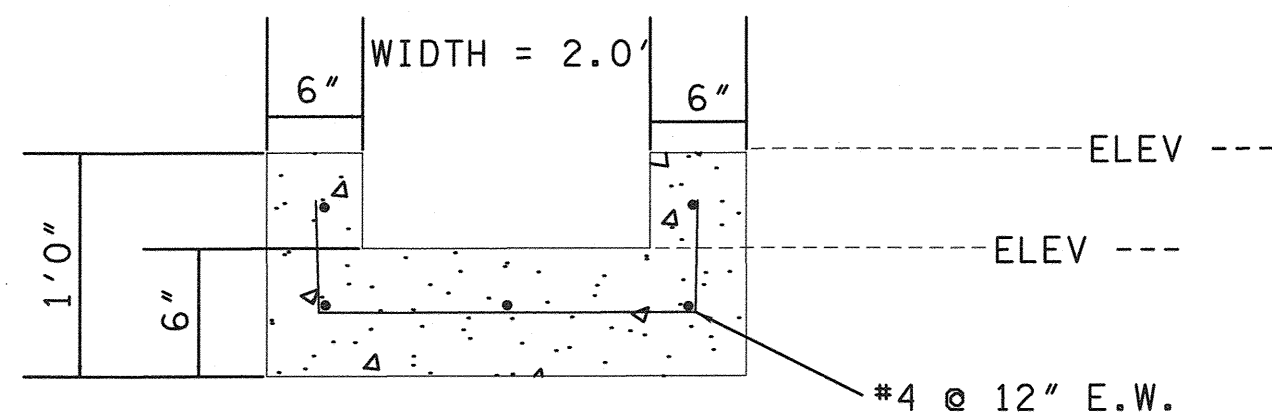

SECTION  
EMERGENCY SPILLWAY

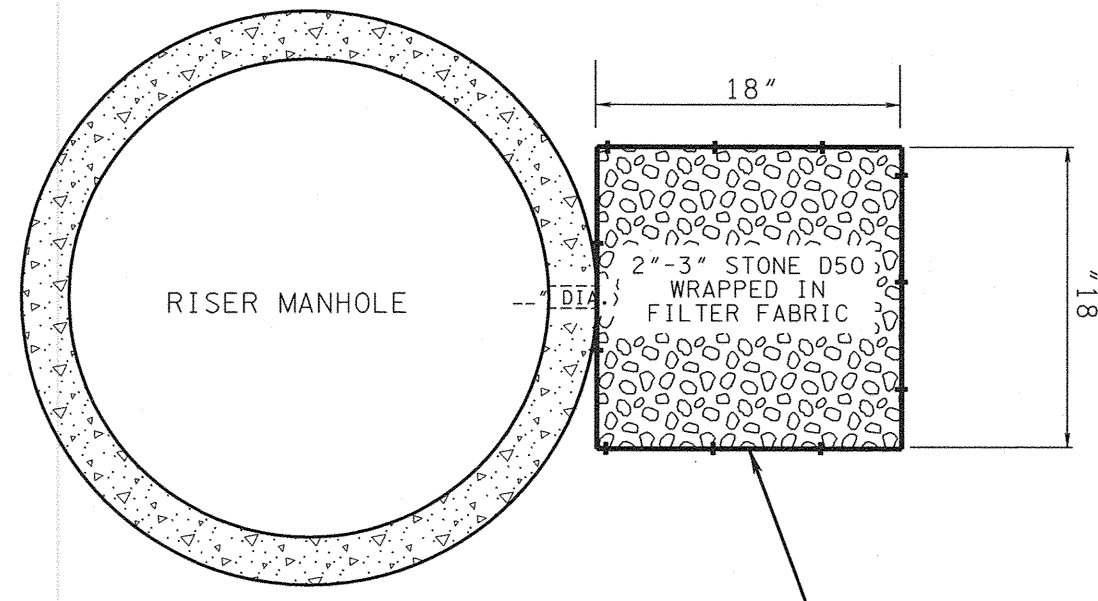

WELDED STEEL BOX WITH WIRE MESH  
WITH HINGED LID ON TOP (MIN #4 REBAR)  
(BOLTED FIRMLY TO CONCRETE PAD)

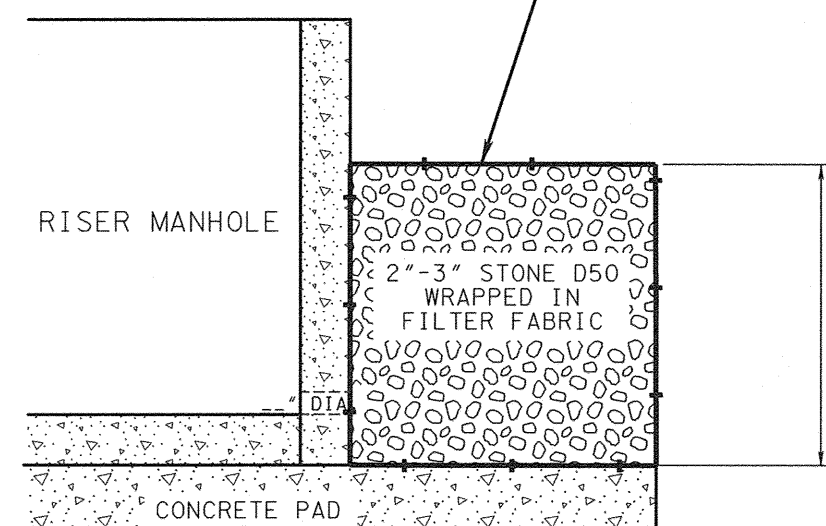

CROSS SECTION

FIRST FLUSH FILTER DETAIL  
WELDED STEEL CAGE

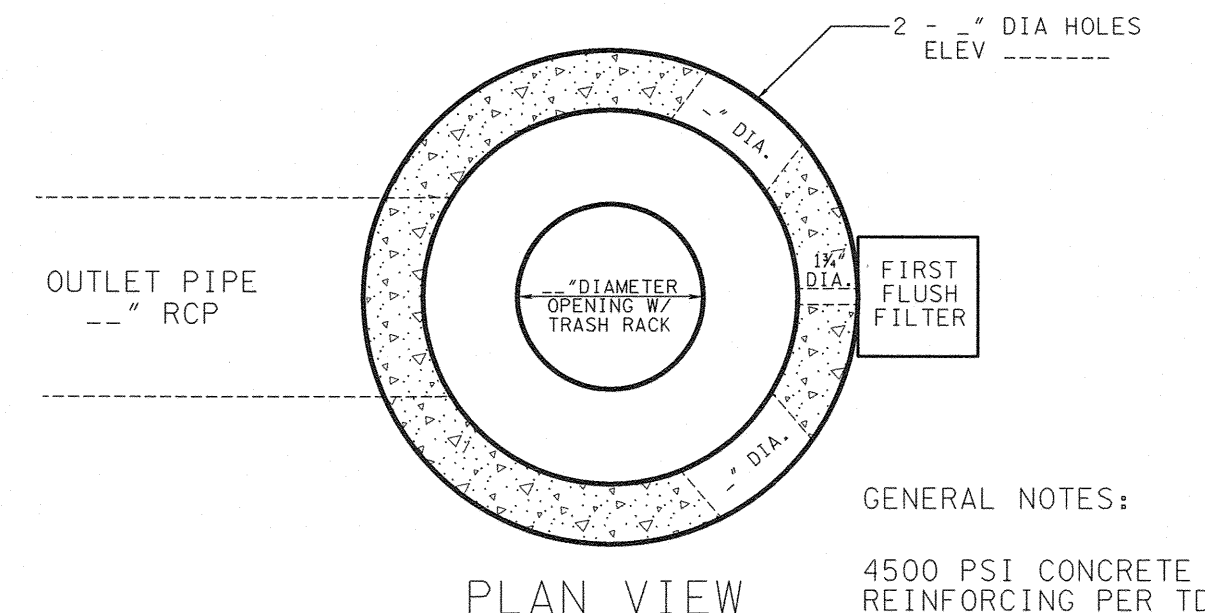
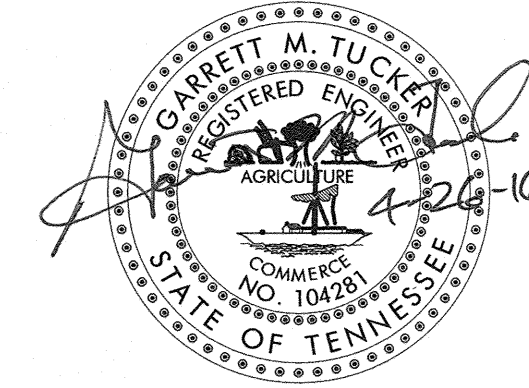

GENERAL NOTES:

4500 PSI CONCRETE  
REINFORCING PER TDOT D-MH-2/3

GROUT FIRST FLUSH FILTER TO  
POND RISER MANHOLE

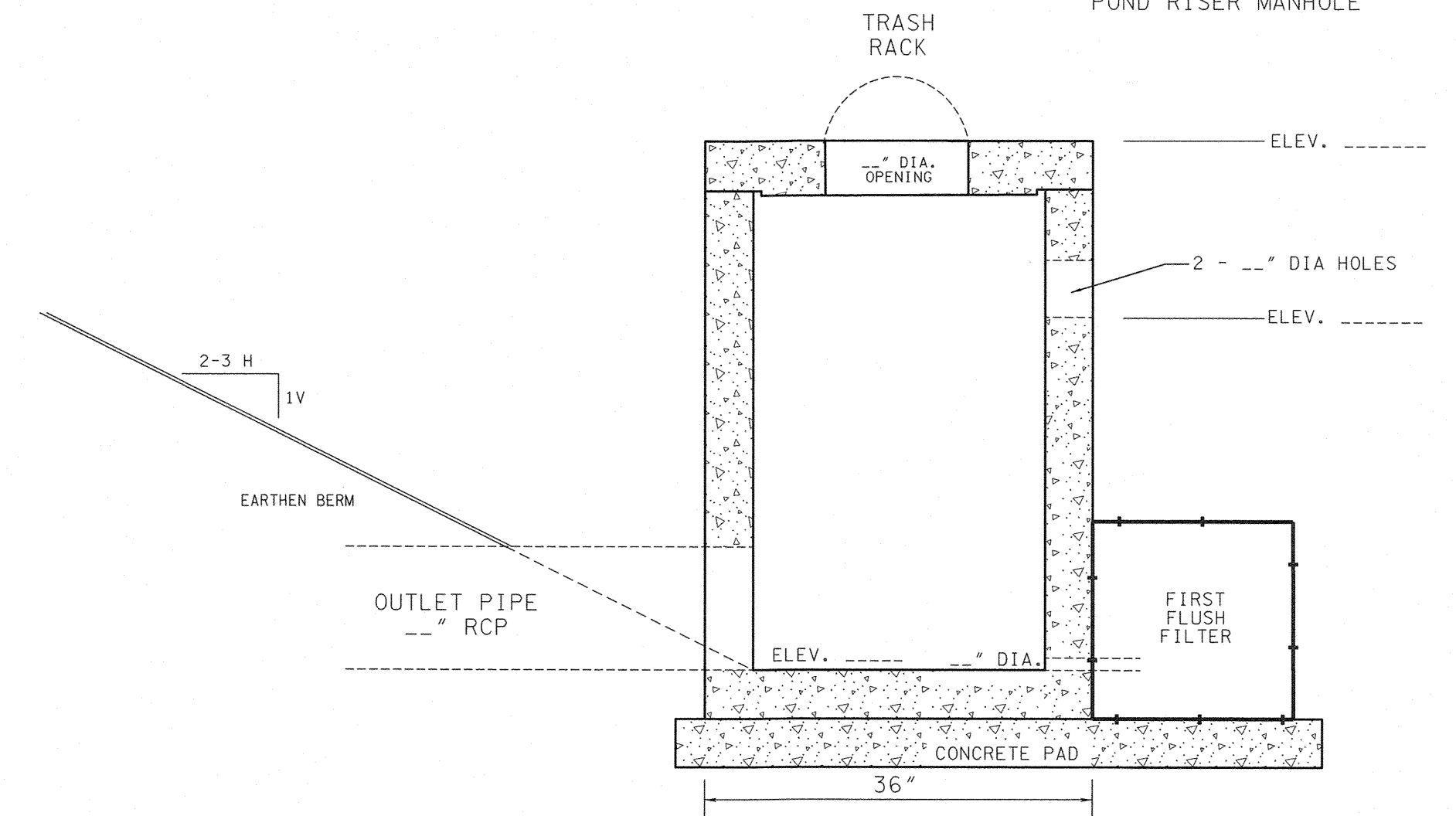

CROSS SECTION

RISER DETAIL

STANDARD PRE-CAST MANHOLE  
OR CONCRETE BLOCK BOX

NOTES:

- 1) INSTALL POND AS FIRST ITEM OF CONSTRUCTION. SEED & STABILIZE IMMEDIATELY UPON COMPLETION OF GRADING.
- 2) ADAPT AND CONNECT TEMPORARY 18" PVC DEWATERING PIPE TO OUTLET PIPE AND DRILL HOLES FOR OUTLET CONTROL DURING USE AS TEMPORARY SEDIMENT BASIN.
- 3) REMOVE ACCUMULATED SEDIMENT AND DEWATERING PIPE WHEN ALL UPSTREAM AREAS ARE STABILIZED.
- 4) CONSTRUCT AND/OR INSTALL FINAL OUTLET STRUCTURE INCLUDING RISER, FIRST FLUSH FILTER, AND TRASH RACK.
- 5) POND WILL REMAIN FOR PERMANENT STORM WATER DETENTION.

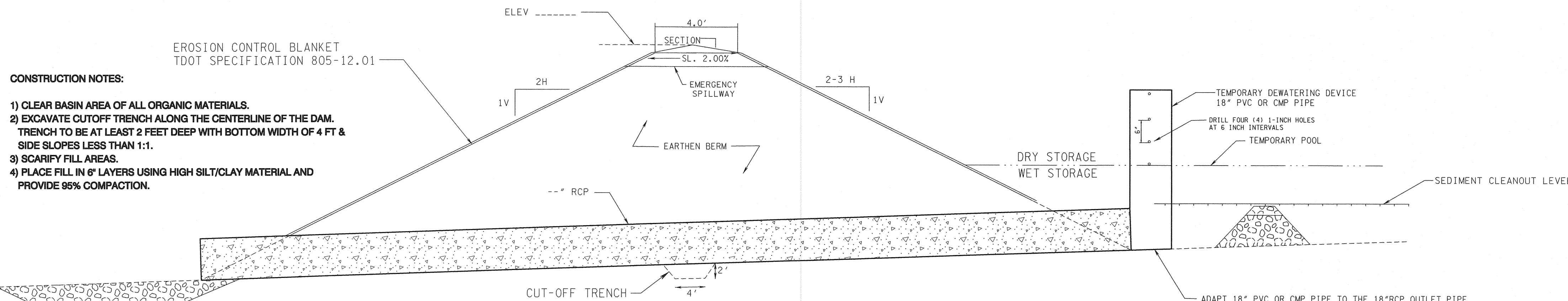

DETENTION POND / TEMPORARY SEDIMENT BASIN  
TYPICAL CROSS-SECTION

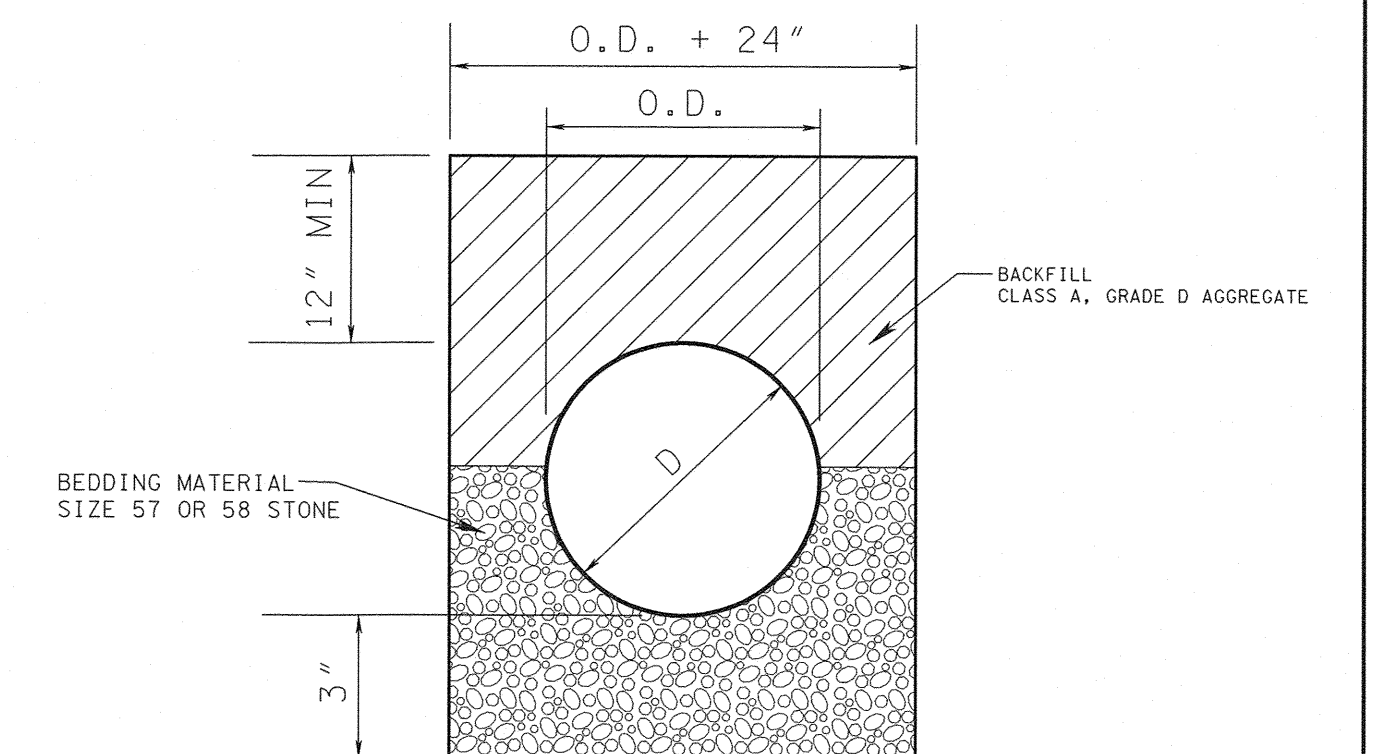

NOTES:

1. NO SIDEWALKS OR PAVEMENT SECTIONS TO BE CUT.
2. BACKFILL SHALL BE COMPACTED, AND BEDDING MATERIAL SHALL BE IN ACCORDANCE WITH CITY OF KNOXVILLE TECHNICAL SPECIFICATIONS FOR STORM SEWERS AND PIPE CULVERTS, SECTION 20.0

PIPE BEDDING DETAIL

| NO SCALE  |      |             |    |      |
|-----------|------|-------------|----|------|
| NO.       | DATE | DESCRIPTION | BY | CKD. |
| REVISIONS |      |             |    |      |

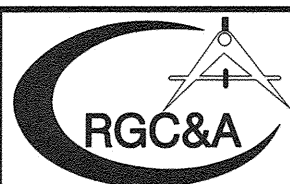

ROBERT G. CAMPBELL & ASSOC., L.P.  
CONSULTING ENGINEERS  
KNOXVILLE, TENNESSEE

EDITH'S PLACE  
CONCEPT PLAN / USE ON REVIEW

DETAILS

|                    |                   |                   |                                       |
|--------------------|-------------------|-------------------|---------------------------------------|
| DESIGNED BY<br>GMT | CHECKED BY<br>RGC | SCALE<br>NO SCALE | SHEET FOUR<br>NO. 4<br>OF FIVE SHEETS |
| DRAWN BY<br>JER    | DATE<br>04/26/16  | FILE NO.<br>16016 |                                       |



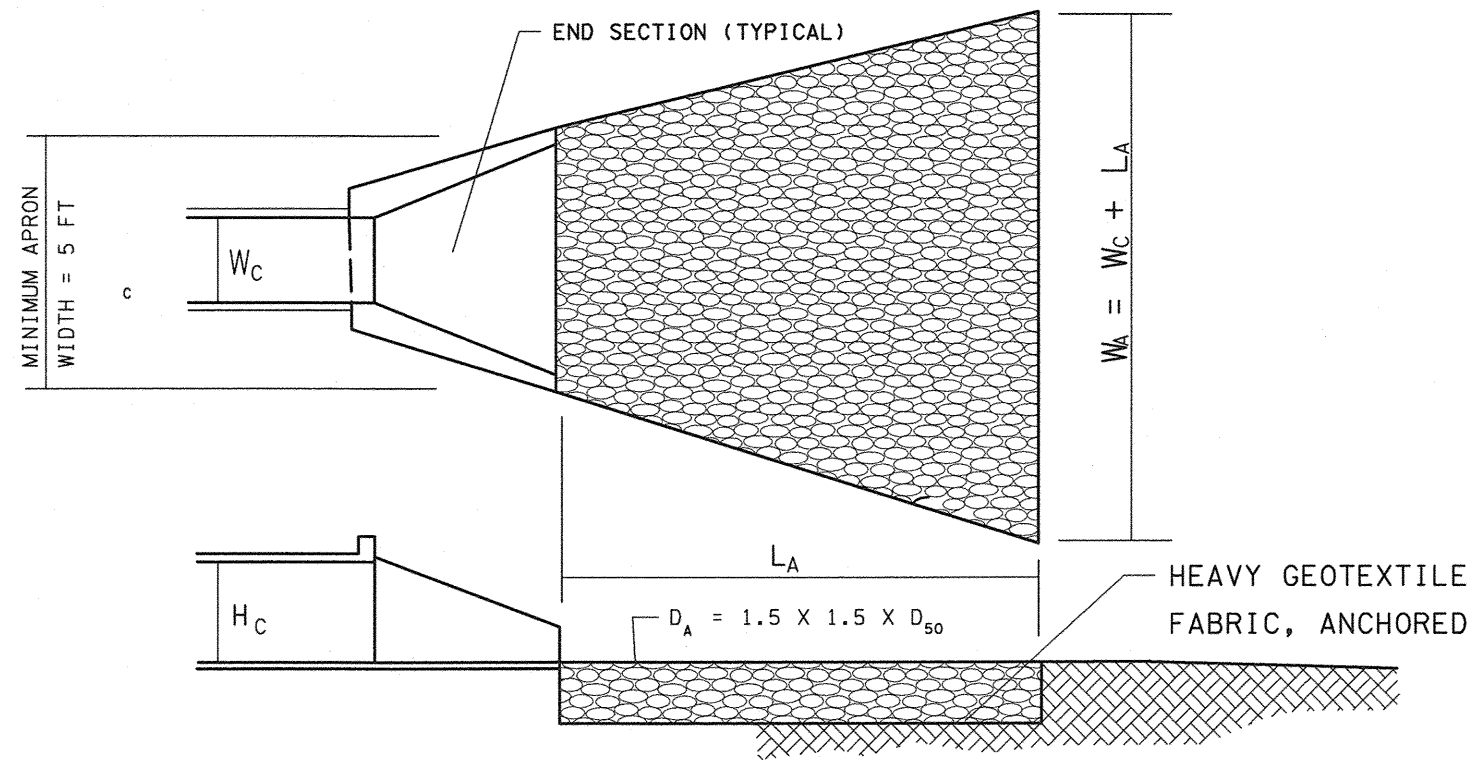

TAILWATER < 0.5 HC AND ASSUMING FULL CULVERT FLOW (LOW TAILWATER CONDITIONS)

HC = HEIGHT OF CULVERT  
WC = WIDTH OF CULVERT  
LA = LENGTH OF RIPRAP APRON  
WA = WIDTH OF RIPRAP APRON AT END  
D50 = MEDIAN RIPRAP SIZE (TABLE ES-25-1)  
Dmax = MAXIMUM SIZE OF RIPRAP = 1.5 D  
DA = DEPTH OF RIPRAP APRON = 1.5 D

RIPRAP OUTLET PROTECTION

18" PIPE  
LA 14'  
WA 16'  
DA 14"  
D50 6"  
Dmax 9"

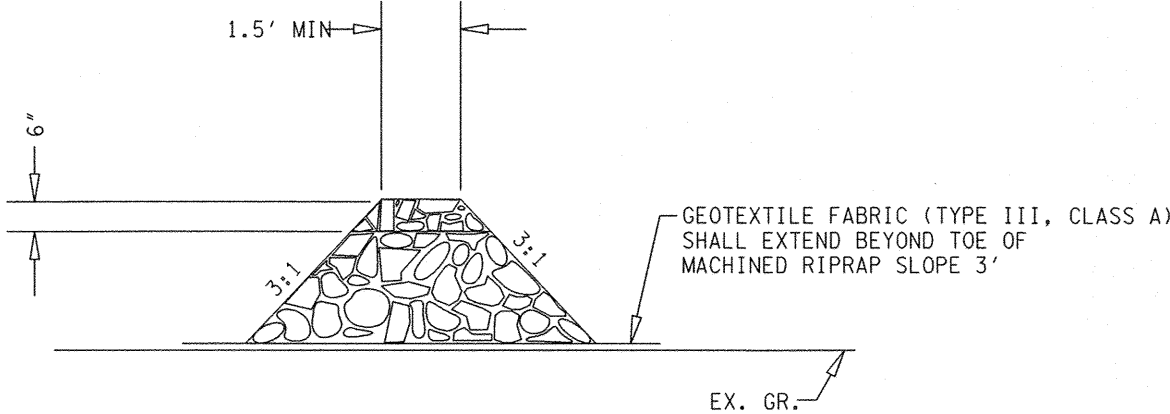
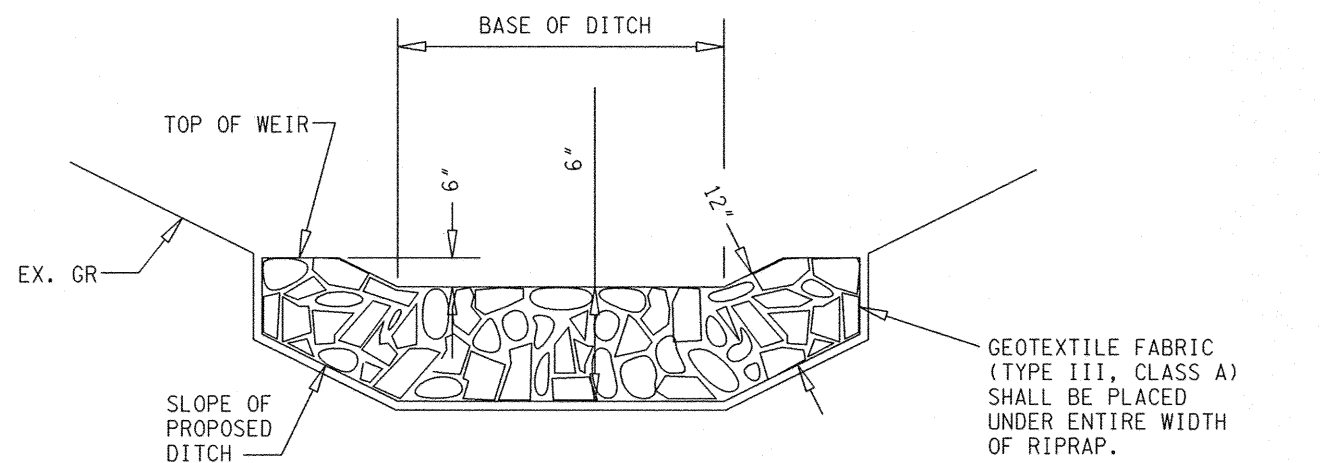
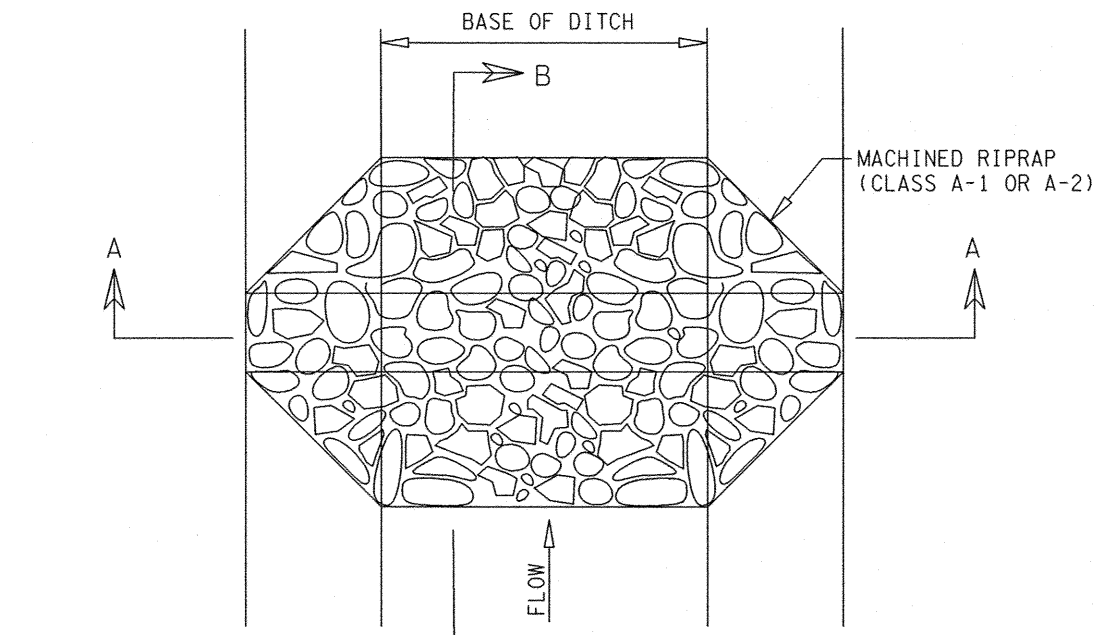

SECTION B-B  
ROCK DAM DETAIL

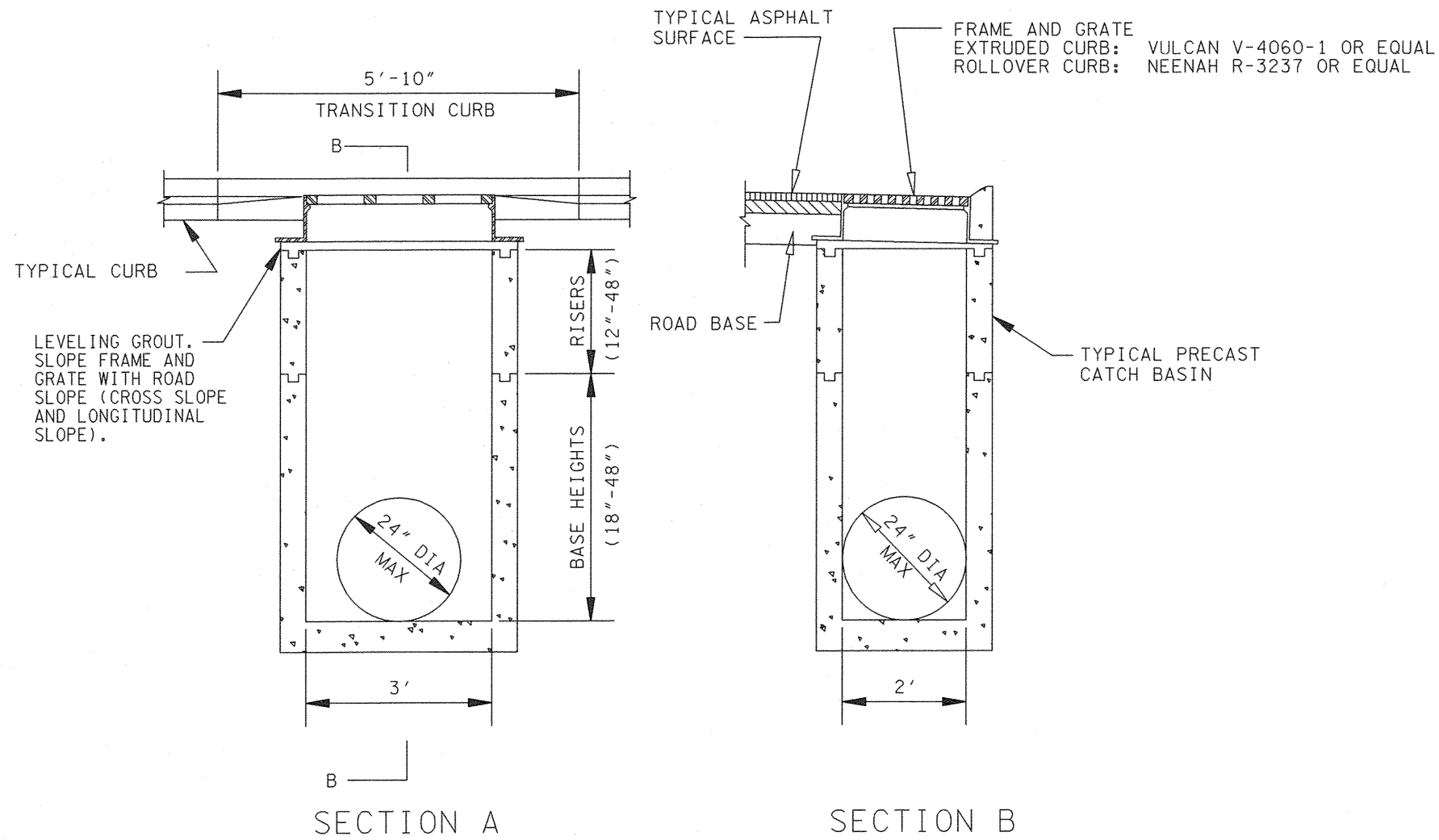
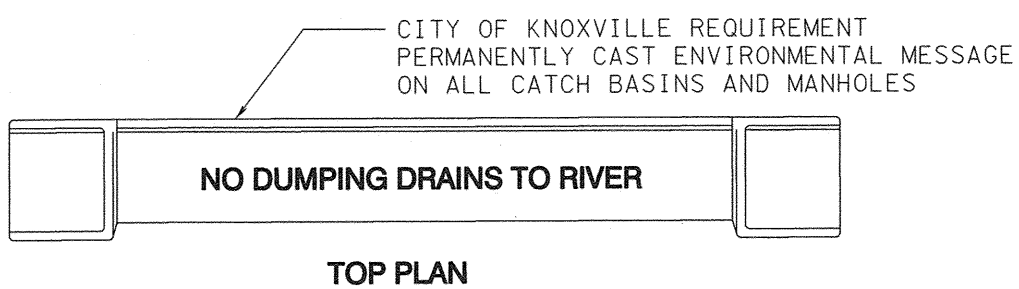

TYPICAL CATCH BASIN DETAIL

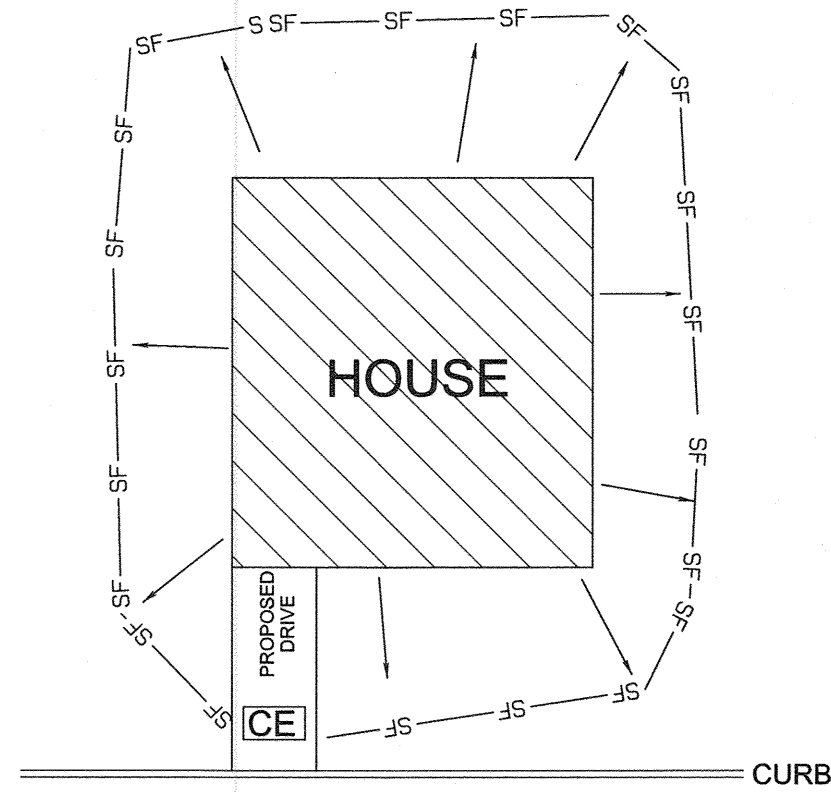

JOINT PERMANENT EASEMENT

GRAVEL CONSTRUCTION EXIT TO EACH BUILDING SITE  
INSTALL SILT FENCE AND/OR HAY BALES ALONG LOWER SIDES OF LOT  
EXTEND PIPES FROM GUTTER DOWNSPOUTS TO STABILIZED AREA UNTIL YARD AREAS ARE STABILIZED.  
EXCAVATE SUMPS AS NECESSARY TO COLLECT EXCESS SEDIMENT

TYPICAL BUILDING

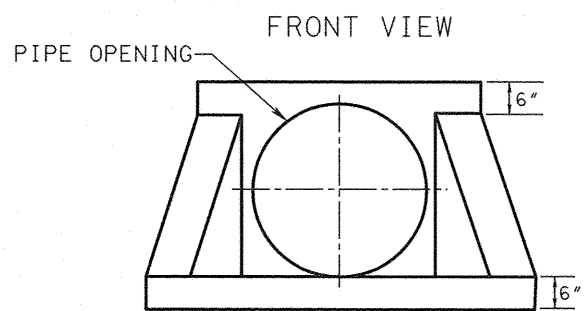
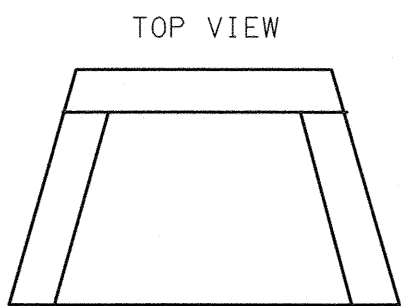

NOTES:  
1. MINIMUM REINFORCING WIRE REINFORCEMENT 4 x 4 W7 x W7  
2. SHERMAN DIXIE PRECAST HEADWALL, DRAWING ET-001 OR EQUAL

ENDWALL DETAIL

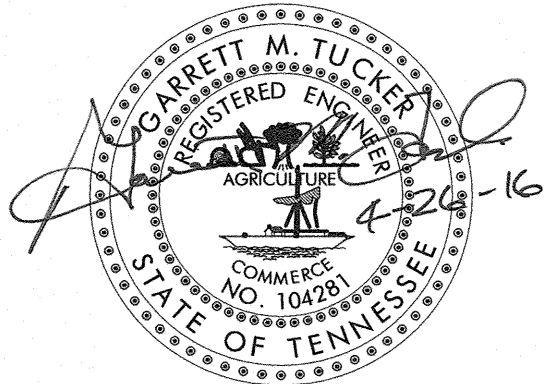

NOTES:

- POST SPACING SHALL BE 8 FEET MAXIMUM FOR TYPICAL APPLICATIONS AT THE BOTTOM OF SLOPES OR ALONG SITE PERIMETER.
- POST SPACING SHALL BE 6 FEET MAXIMUM AT THE BOTTOM OF STEEP SLOPES. POST SPACING SHALL BE 4 FEET MAXIMUM WITHIN A DRAINAGE CHANNEL.
- PLACE SILT FENCE AT LEAST 5 TO 7 FEET AWAY FROM STEEP OR LONG SLOPES TO IMPOUND STORMWATER RUNOFF. SEE FIGURE ES-14-3.

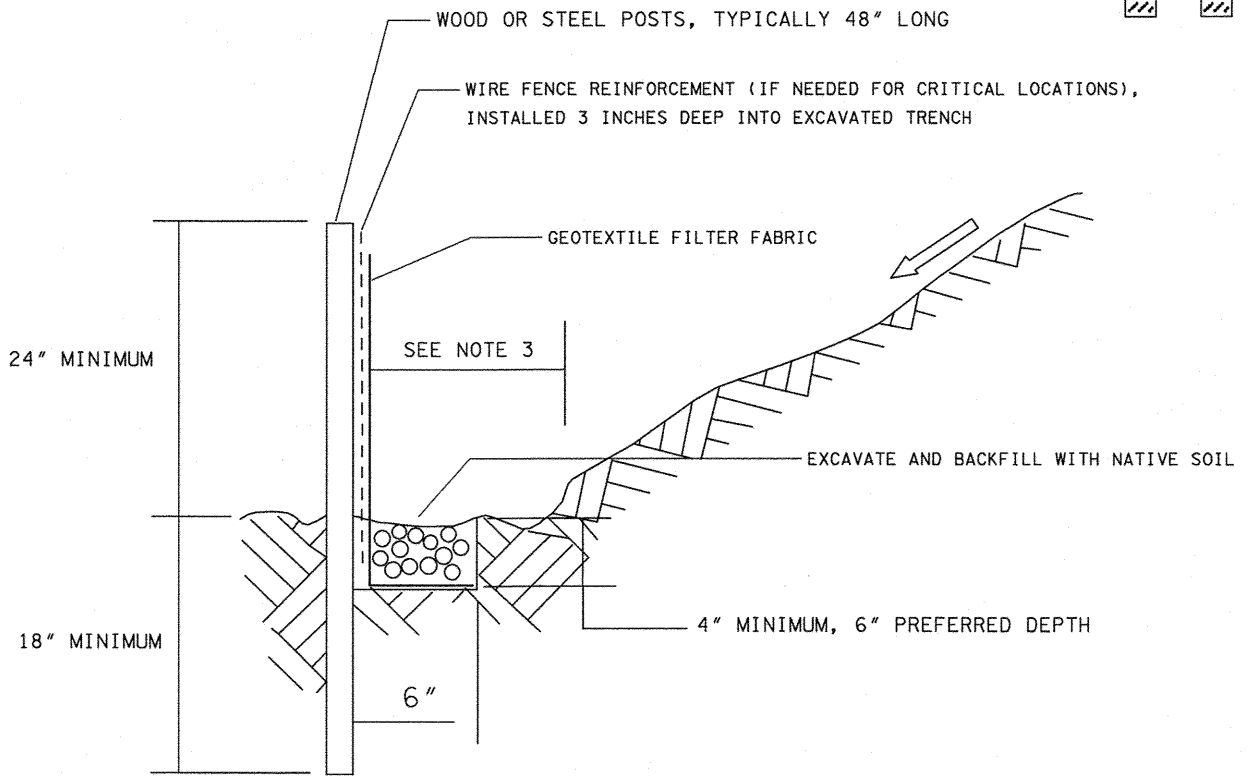
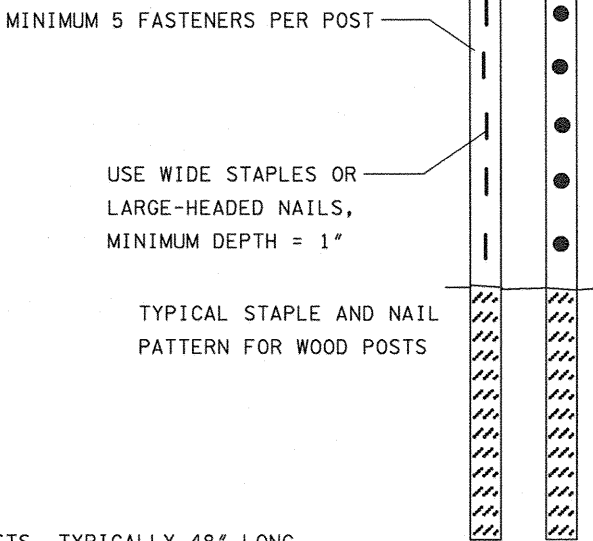

TYPICAL SILT FENCE INSTALLATION

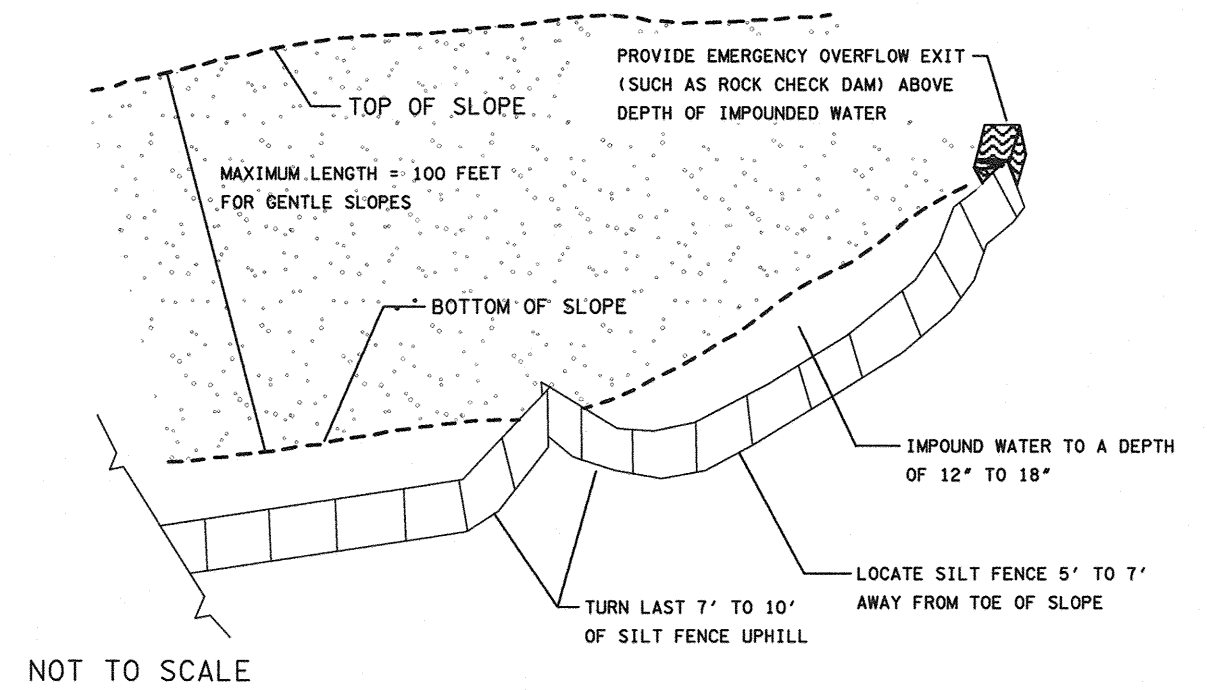

SILT FENCE (BELOW A STEEP OR LONG SLOPE)

Revised: 4/27/2016  
5-SC-16-C  
5-F-16-UR

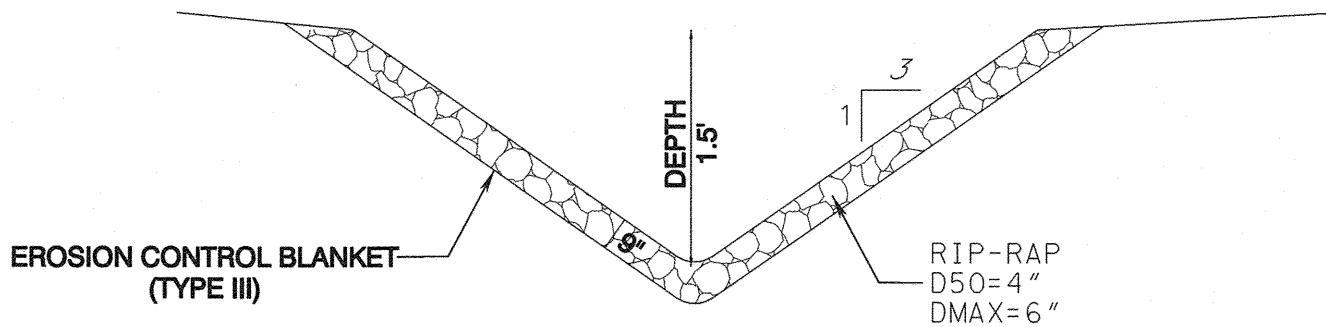

RIP-RAP SWALE  
TYPICAL DETAIL

| NO SCALE  |      |             |    |
|-----------|------|-------------|----|
| NO.       | DATE | DESCRIPTION | BY |
| REVISIONS |      |             |    |

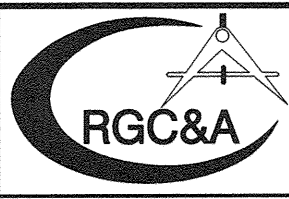

ROBERT G. CAMPBELL & ASSOC., L.P.  
CONSULTING ENGINEERS  
KNOXVILLE, TENNESSEE

EDITH'S PLACE  
CONCEPT PLAN / USE ON REVIEW

DETAILS

|                    |                   |                   |                                       |
|--------------------|-------------------|-------------------|---------------------------------------|
| DESIGNED BY<br>GMT | CHECKED BY<br>RGC | SCALE<br>NO SCALE | SHEET FIVE<br>NO. 5<br>OF FIVE SHEETS |
| DRAWN BY<br>JER    | DATE<br>04/26/16  | FILE NO.<br>16016 |                                       |