

STREET PROFILE

1" = 100' HORIZ
1" = 10' VERTICAL

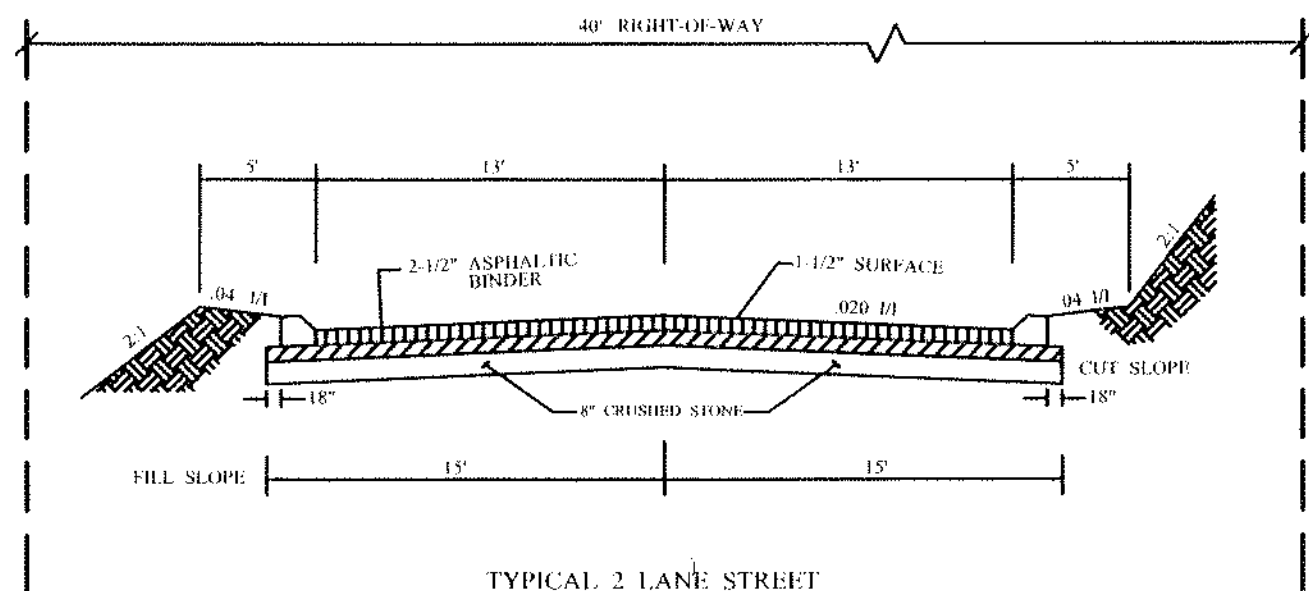

BORROW MATERIAL TO BE USED FOR FILL WILL BE TESTED FOR MAXIMUM DRY DENSITY AND OPTIMUM MOISTURE CONTENT (STANDARD PROCTOR ASTM D698) PRIOR TO PLACEMENT OF FILL.

FILL SOILS WILL BE COMPACTED IN LAYERS 8 INCHES OR LESS IN THICKNESS TO A MINIMUM OF 98 PERCENT STANDARD PROCTOR MAXIMUM DRY DENSITY AND WITHIN PLUS OR MINUS 3 PERCENT OPTIMUM MOISTURE CONTENT. SW (Q) DENSITY TESTS SHOULD BE PERFORMED NO LESS THAN EVERY 10,000 SQUARE FEET OF AREA PER 8-INCH LIFT (APPROX. 1 TEST PER EVERY 50 FEET).

COMPACTION TESTING OF ROADWAY, TO BE PERFORMED AND INSPECTED IN ACCORDANCE WITH KNOX COUNTY REQUIREMENTS.

CERTIFICATION OF CONCEPT PLAN

I hereby certify that I am a registered engineer, licensed to practice engineering under the laws of the State of Tennessee. I further certify that the plan and accompanying drawings, documents and statements conform to all applicable provisions of the *Knoxville-Knox County Subdivision Regulations* except as has been itemized and described in a report filed with the Metropolitan Planning Commission.

Registered Engineer *[Signature]*
Tennessee Certificate No. *15416*

Signed: _____ Date: _____
Secretary

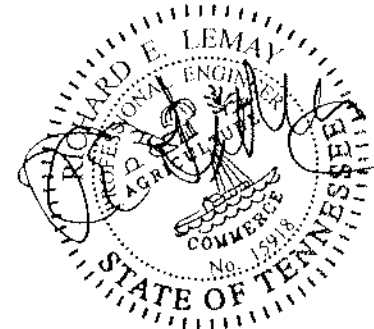

SITE NOTES

- Corner monuments as shown hereon
- Verify exact size, depth and location of all underground utilities prior to construction.
- 10' utility and drainage easement inside all exterior boundary lines, 5' each side all interior lot lines.
- Property recorded: Instrument # 200506200102629
- Map 153, Insert L, Group A, Parcel 7
- Property Zoned: PR
- Total Area: 1.84 acres - 80,150 sq.ft.
- Total Lots: 8
- Property subject to all applicable easements, setbacks and restrictions of record.
- Setbacks: Front 20', Side 5', Rear 35', PERIPHERAL 35'
- Access from internal street only.
- Existing structures to be removed.
- TDOT entrance permit required for access.



CONCEPT PLAN

U.O.R.

DATE *5.26.06*

UTILITIES:
WATER: FUD
SEWER: FUD
GAS: KUB
ELECTRICITY: LCUB
CABLE TV: CHARTER

OWNER
WARD PAUL JEFFREY
10419 NORTHSHORE DR
KNOXVILLE, TENNESSEE 37922
(865) 966-9401

REVISED

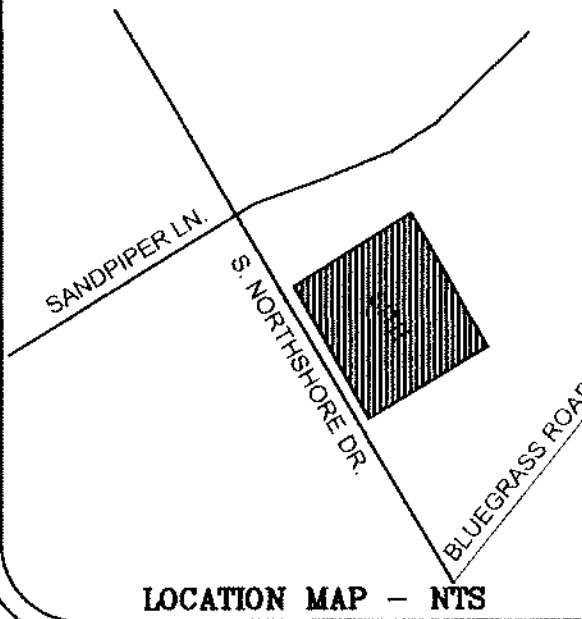
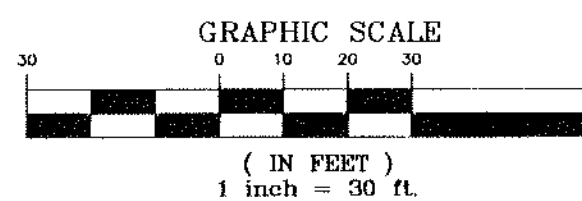

REV DATE	BY
05-18-06	
05-25 -06	

**LEMAI AND ASSOCIATES
CONSULTING ENGINEERS**
10816 KINGSTON PIKE
KNOXVILLE, TENNESSEE 37922
PH: (865) 671-0183 FAX: (865) 671-0213

CONCEPT PLAN
THE BEACON AT NORTHSHORE
DISTRICT 6* KNOX COUNTY* TENNESSEE

DRAWN REL.
CHECKED REL.
DATE 5-25-2006
SCALE 1"=30'
SHEET <u>1</u> OF <u>1</u> SHTS
JOB NUMBER 4658