

ENGINEER:
ROBERT G. CAMPBELL
AND ASSOCIATES
7523 TAGGART LANE
KNOXVILLE, TN 37938
PHONE: (865) 947-5996
FAX: (865) 947-7556

DEVELOPER:
KOONTZ-WILSON, LLC.
GARY KOONTZ
3232 TAZEVELL PIKE
KNOXVILLE, TN 37918
PHONE: (865) 688-1155

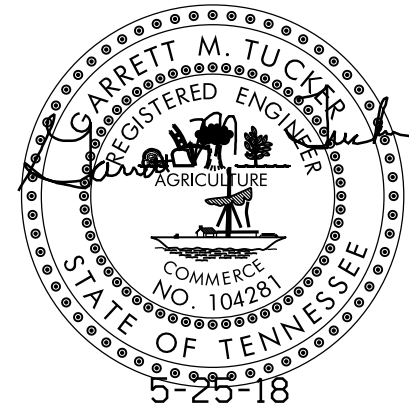

- NOTES:
- 1) FOUNTAINHEAD LANE TO BE EXTENDED AS PUBLIC ROAD WITH CUL DE SAC TURNAROUND AS SHOWN.
 - 2) NEW PRIVATE JOINT PERMANENT EASEMENTS TO BE CONSTRUCTED WITH ALL UNITS ACCESSING FROM INTERNAL PRIVATE ROADS.
 - 3) REGIONAL STORMWATER DETENTION BASIN TO BE DESIGNED AND CONSTRUCTED BY KNOX COUNTY ENGINEERING AND PUBLIC WORKS UPSTREAM OF PROPOSED SUBDIVISION.
 - 4) ON SITE DETENTION POND TO BE CONSTRUCTED IN SERIES DOWNSTREAM FOR FOUNTAINHEAD VILLAGE BY DEVELOPER. TO BE COORDINATED WITH REGIONAL POND.
 - 5) UNDERGROUND INJECTION WELL PERMITS TO BE OBTAINED IF MODIFICATIONS ARE REQUIRED TO EXISTING SINKHOLE DEPRESSION AREAS.
 - 6) EXISTING SANITARY SEWER TO BE RELOCATED AS SHOWN.
 - 7) EXISTING CONTOURS FROM KGIS.
 - 8) LOCATIONS OF UNDERGROUND UTILITIES SHOWN ARE APPROXIMATE. THERE MAY BE OTHER UTILITIES NOT SHOWN. PRIOR TO ANY EXCAVATION, THE OWNER AND/OR CONTRACTOR IS RESPONSIBLE FOR CONTACTING THE LOCAL UTILITY AUTHORITIES FOR EXACT LOCATIONS AND DEPTHS.
 - 9) PREVIOUSLY RECORDED 20' DRAINAGE EASEMENT TO BE RE-DEDICATED FOR POND OUTLET PIPE AS SHOWN WITH ADDITIONAL OFF-SITE DRAINAGE EASEMENT AS NEEDED.

Revised: 5/29/2018

CURVE DATA

CURVE C1 P.I. 20+79.95 P.C. 20+65.61 PT 20+94.10 Δ 16° 19' 21" (RT) D 57° 17' 45" R 100.000 L 28.488 T 14.341	CURVE C2 P.I. 21+76.94 P.C. 21+48.66 PT 22+03.78 Δ 31° 34' 49" (LT) D 57° 17' 45" R 100.000 L 55.118 T 28.278
CURVE C3 P.I. 31+12.02 P.C. 30+53.84 PT 31+59.22 Δ 60° 22' 59" (LT) D 57° 17' 45" R 100.000 L 105.388 T 58.182	CURVE C4 P.I. 33+09.82 P.C. 32+67.76 PT 33+47.38 Δ 45° 36' 55" (LT) D 57° 17' 45" R 100.000 L 79.614 T 42.052

VARIANCES:

1) REDUCE PERIPHERAL SETBACK FROM 35' TO 25'
DUE TO IRREGULAR SHAPE OF PARCEL.

CLT MAP: 49J GROUP D
PARCEL: 004
DEED REFERENCE: 20120719 - 0003735
TOTAL AREA: 5.81 ACRES
NUMBER OF LOTS: 22
PROPERTY ZONED: PR

MPC FILE NUMBER: 6-SB-18-C & 6-N-18-UR

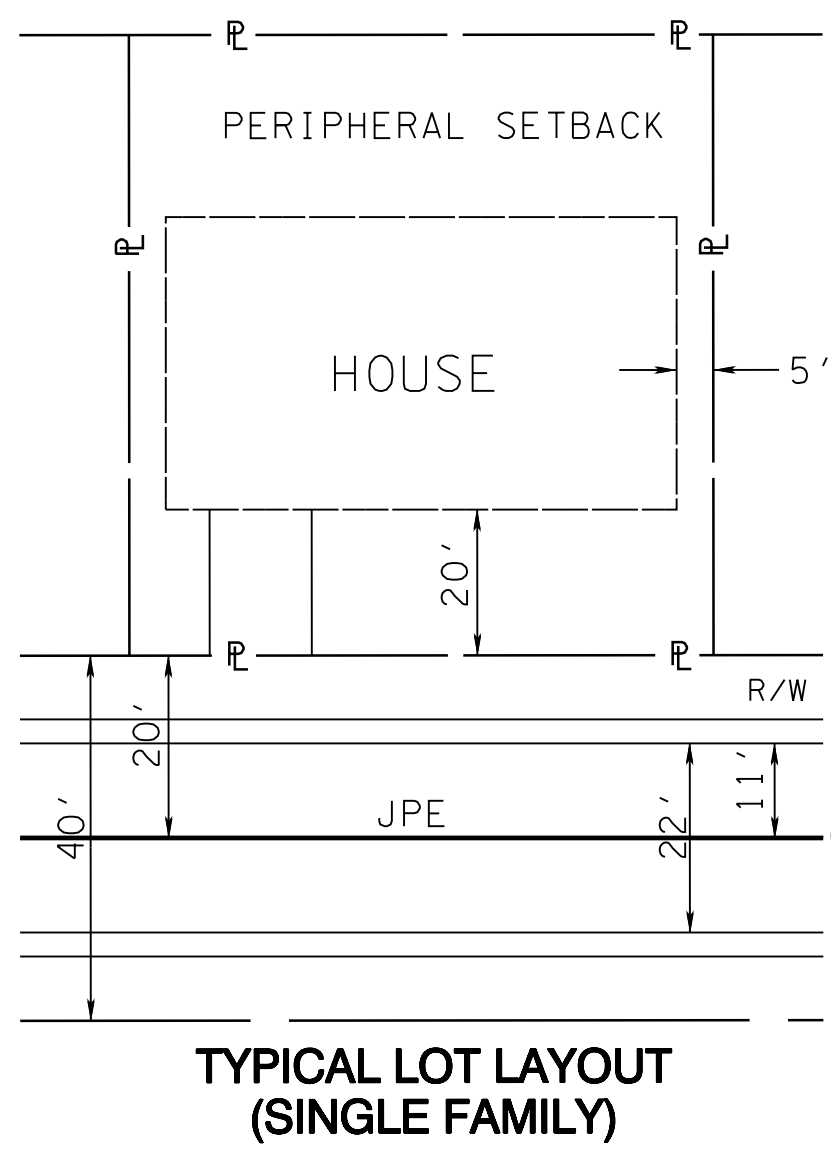

NO.	DATE	DESCRIPTION	BY	CHKD.

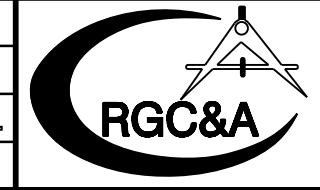

ROBERT G. CAMPBELL & ASSOC., L.P.
CONSULTING ENGINEERS
KNOXVILLE, TENNESSEE

FOUNTAINHEAD VILLAGE
CONCEPT PLAN / USE ON REVIEW

GENERAL LAYOUT
PLAN VIEW

DESIGNED BY GMT	CHECKED BY RGC	SCALE 1" = 40'	SHEET TWO NO. 2
DRAWN BY JER	DATE 5-25-18	FILE NO. 02100	OF THREE SHEETS