

TYPICAL ROAD SECTION
THRU 50' ROAD
"PUBLIC ROAD"

* "D" MIX REQUIRED IF ROAD GRADE IS 10% OR GREATER

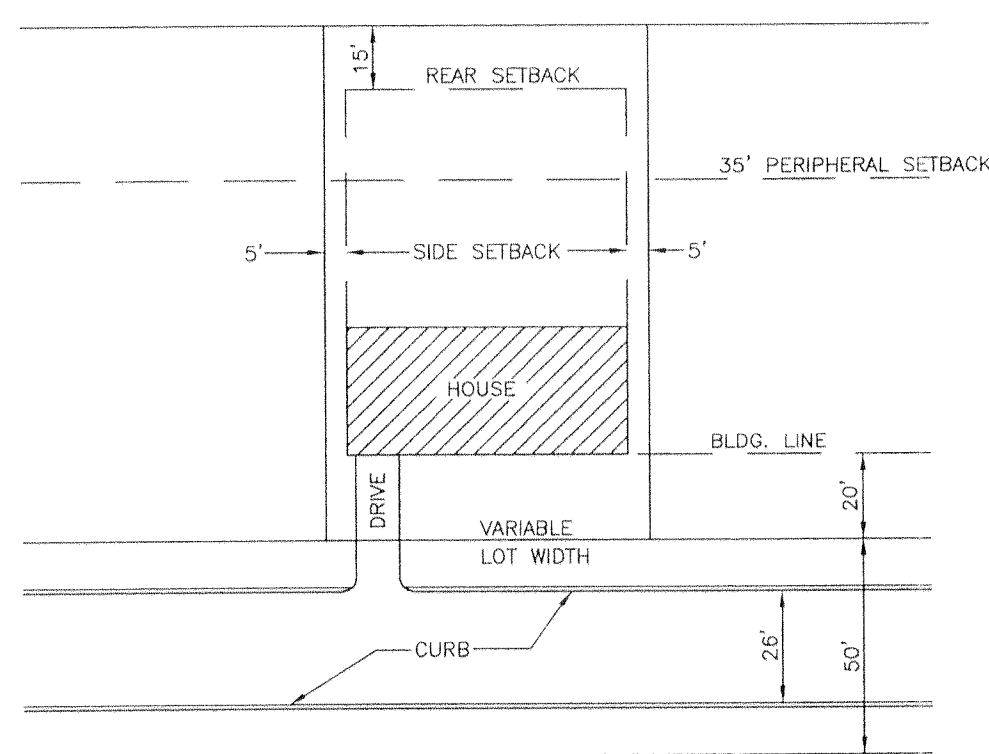

TYPICAL LOT LAYOUT
NTS

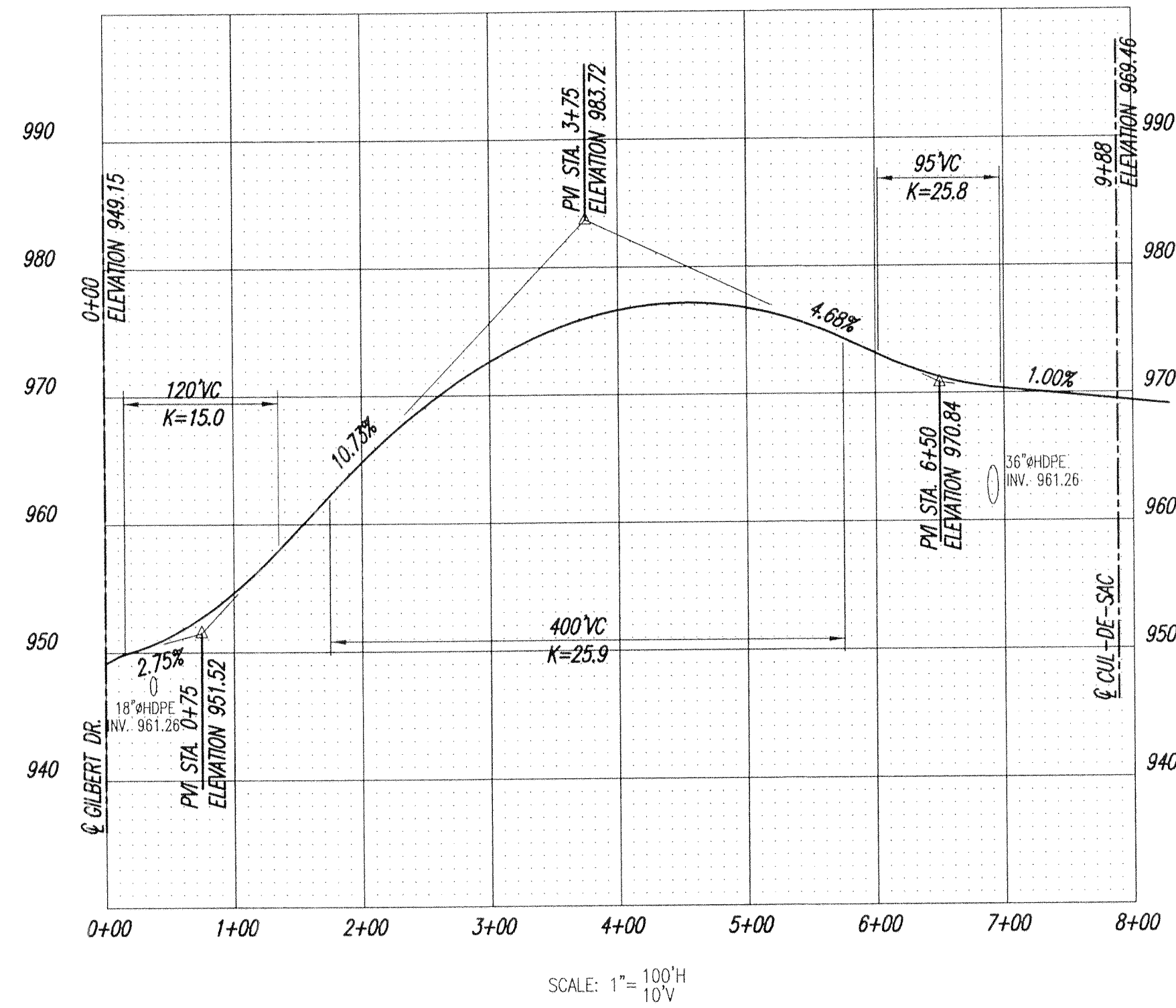

SCALE: 1"= 100'H
10'V

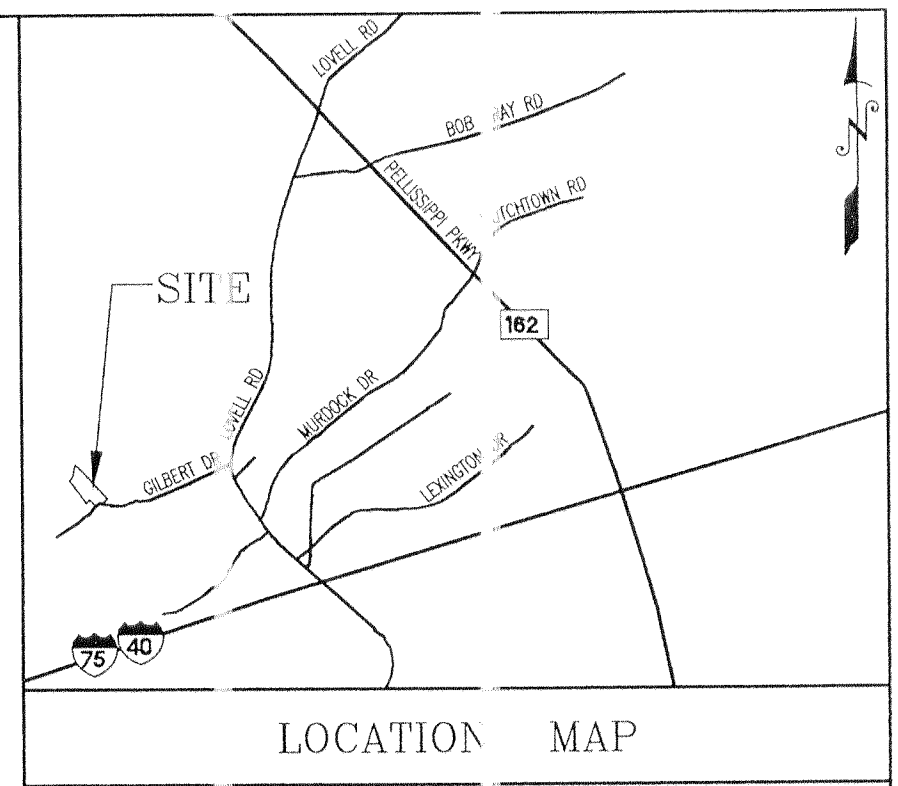

LOCATION MAP

- NOTES:
1. ALL DIMENSIONS ARE SCALED AND SUBJECT TO CHANGE ON THE FINAL PLAN.
 2. A 10' DRAINAGE, UTILITY AND CONSTRUCTION EASEMENT EXISTS INSIDE ALL EXTERIOR LOT LINES AND ROAD LINES, 5' EACH SIDE OF INTERIOR ROAD LINES.
 3. A 15' UTILITY EASEMENT EXISTS 7.5' EACH SIDE OF CENTERLINE OF SANITARY SEWER AS INSTALLED.
 4. THIS PROPERTY CONTAINS APPROXIMATELY 7.64 ACRES SUBDIVIDED INTO 21 SINGLE FAMILY DETACHED LOTS.
 5. THIS PROPERTY IS ZONED PR.
 6. ALL ROAD PROFILES ARE BASED ON B+N&P FIELD SURVEY.
 7. UTILITIES:
WATER: FIRST UTILITY DISTRICT
SEWER: FIRST UTILITY DISTRICT
ELECTRIC: KNOX CITY UTILITY BOARD
GAS: KNOXVILLE UTILITIES BOARD
TELEPHONE: A&T SOUTHEAST
 8. NO VARIANCES REQUIRED.
 9. COMPACTION TESTING PURSUANT TO THE REQUIREMENTS OF THE KNOX COUNTY DEPT. OF ENGINEERING & PUBLIC WORKS WILL BE REQUIRED FOR ALL FILL AREAS.
 10. ROADWAY GRADES AT INTERSECTIONS BETWEEN 12' AND 35' HAVE BEEN REVIEWED AND APPROVED BY KNOX COUNTY DEPT. OF ENGINEERING AND PUBLIC WORKS.
 11. THE PURPOSE OF THIS REVISED CONCEPT & DEVELOPMENT PLAN IS TO INCORPORATE THE COMMON AREAS INTO THE ADJACENT LOTS.
 12. SLOPES ON THE REAR LOT LINE NORTHEAST OF GILBERT STATION LANE MUST BE STABILIZED TO A 2:1 MAXIMUM SLOPE.

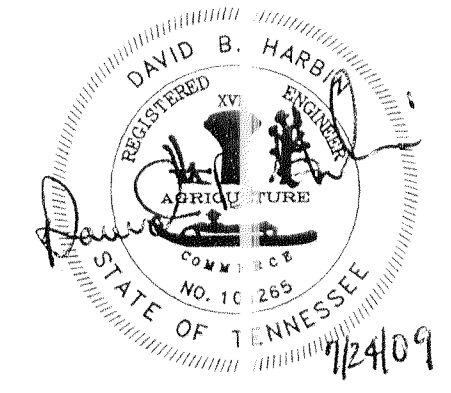

CERTIFICATION OF CONCEPT PLAN.
I HEREBY CERTIFY THAT I AM A REGISTERED ENGINEER, LICENSED TO PRACTICE ENGINEERING UNDER THE LAWS OF THE STATE OF TENNESSEE. I FURTHER CERTIFY THAT THE PLAN AND ACCOMPANYING DRAWINGS, DOCUMENTS AND STATEMENTS CONFORM TO ALL APPLICABLE PROVISIONS OF THE KNOXVILLE-KNOX COUNTY SUBDIVISION REGULATIONS EXCEPT AS HAS BEEN ITICIZED AND DESCRIBED IN A REPORT FILED WITH THE METROPOLITAN PLANNING COMMISSION.
REGISTERED ENGINEER: David B. Harbison
TENNESSEE CERTIFICATE NO. 10265

REVISED
7-24-09

OWNER/DEVELOPER:
THOMAS C. BEELER
P. O. BOX 23313
KNOXVILLE, TENNESSEE 37933
PHONE: (865) 986-0650



BATSON, HIMES, NORVELL & POE
REGISTERED ENGINEERS & LAND SURVEYORS
4334 PAPERMILL DRIVE
KNOXVILLE, TENNESSEE 37909
PHONE (865) 588-6472
FAX (865) 588-6473
email@bhn-p.com

REV.	DATE	MPC COMMENTS	REVISION DESCRIPTION
1	07/24/09		
REVISED CONCEPT & DEVELOPMENT PLAN FOR GILBERT STATION S/D			
CLT MAP 130, PARCEL 148.01		SCALE AS NOTED	DRAWN BY TPD DATE 6/24/09
DISTRICT 6, KNOX COUNTY, TN			
CONTOUR INTERVAL = 2' SHEET 1 OF 1 SHEETS		DRAWING NUMBER 24401-SP	