

PLANTING SCHEDULE													
QTY	BOTANICAL NAME	COMMON NAME	CALIPER	TYPE	SPACING	PLANTING HEIGHT	PLANTING WIDTH	MATURE HEIGHT	MATURE SPREAD	SUNLIGHT	SOIL CONDITIONS	SYMBOL	REMARKS
18	Ilex Crenata 'Sky Pencil'	Sky Pencil Holly	N/A	UNDERSTORY EVERGREEN	10'-0" O.C.	4-5 FT	N/A	8 FT	2-3 FT	FULL OR PARTIAL	WELL DRAINED		#7 CONTAINER

LANDSCAPE NOTES:

- ALL PLANT MATERIAL SHALL CONFORM TO THE STANDARDS SET FORTH THE CURRENT EDITION OF AMERICAN STANDARDS FOR NURSERY STOCK OF NURSERYMEN.
- PLANTING PLAN TAKES PRECEDENCE OVER PLANT LIST.
- ALL TREES SHALL BE STAKED OR GUYED AT TIME OF PLANTING UNLESS NO STAKES IS PRE-APPROVED BY OWNER. STAKES OR GUYS SHALL NOT RESTRICT MOVEMENT OF THE PLANT, BUT SHALL HAVE 2"-3" OF SLACK IN EACH GUY WIRE.
- ALL PLANT MATERIAL IS SUBJECT TO THE OWNERS APPROVAL PRIOR TO INSTALLATION TO INSURE THE CONFORMITY TO THE SPECIFICATIONS.
- APPLY GRANULAR PRE-EMERGENT HERBICIDE TO SOIL PER MANUFACTURERS RECOMENDATIONS BELOW MULCH BED PRIOR TO MULCH APPLICATION.
- APPLY "LESCO" (OR EQUAL) GRANULAR SLOW RELEASE FERTILIZER PER MANUFACTURERS RECOMENDATIONS TO TREES AT TIME OF PLANTING.
- PLACE 3"-4" MIN. THICKNESS OF SHREDDED BROWN HARDWOOD MULCH 10' WIDE AROUND FENCED AREA AS SHOWN ON PLAN. IF NECESSARY, INSTALL METAL OR PVC EDGING STRIPS TO PREVENT MULCH FROM WASHING ONTO ROAD OR OTHERWISE CAUSING PROBLEMS.
- CONTRACTOR SHALL WARRANTY PLANTS FOR A PERIOD OF 1 YEAR AFTER FINAL ACCEPTANCE.

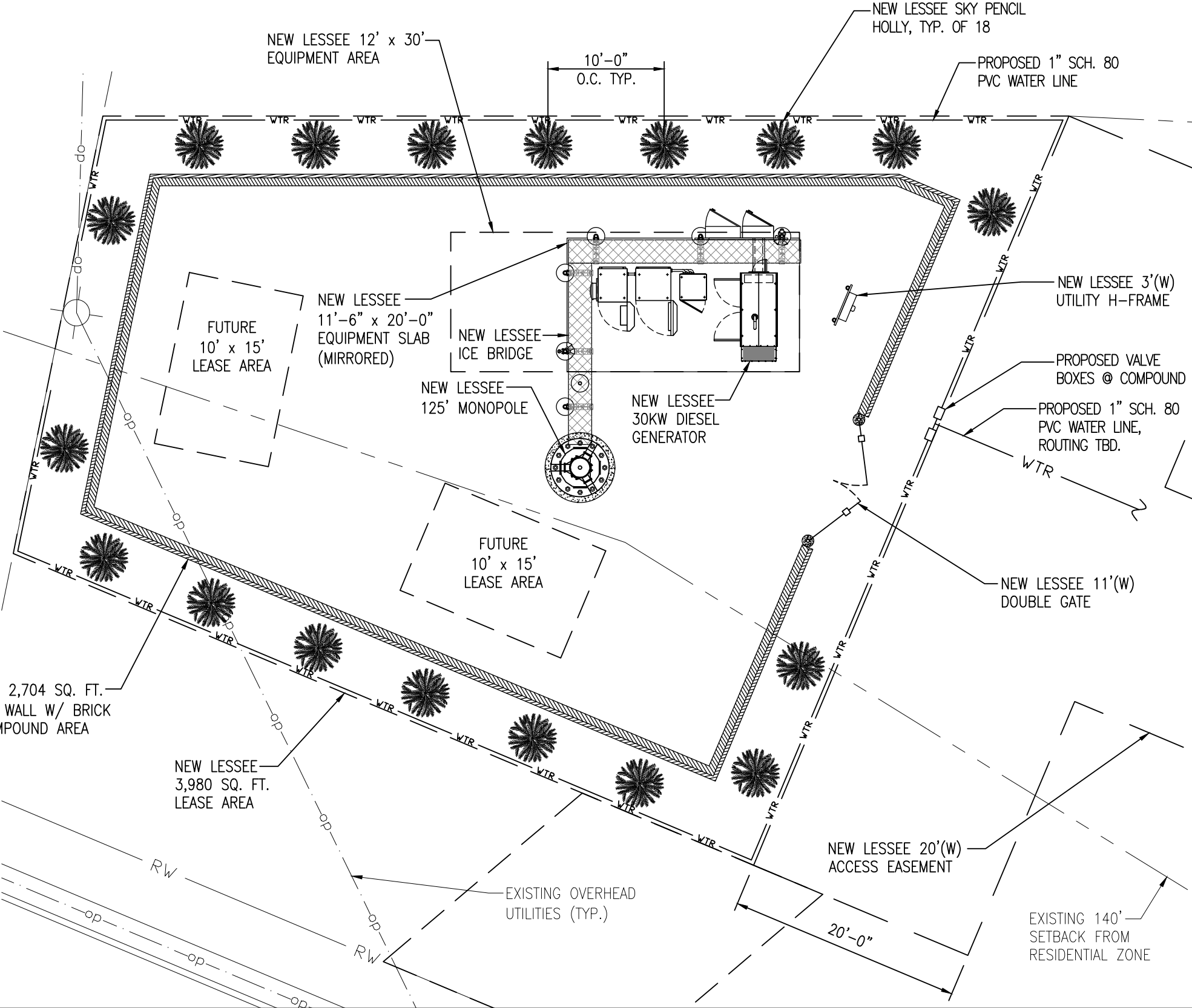

9-B-16-UR

Revised: 11/21/2016



**LESSEE**



1961 NORTHPOINT BLVD, SUITE 130  
HIXSON, TN 37343  
PH: 423-843-9500  
FAX: 423-843-9509

THE INFORMATION CONTAINED IN THIS SET OF DOCUMENTS IS PROPRIETARY BY NATURE. ANY USE OR DISCLOSURE OTHER THAN THAT WHICH RELATES TO THE CLIENT IS STRICTLY PROHIBITED.

A&E PROJECT #:	20141053568
DRAWN BY:	BNS
CHECKED BY:	CTD

REVISIONS		
NO.	DATE	DESCRIPTION
1	11/18/16	ADD LANDSC. & IRRIGATION
2	09/20/16	COMPOUND FENCE CHANGED
3	07/07/16	CONSTRUCTION ISSUE
4	06/14/16	PRELIMINARY REVIEW

PROJECT No.	20141053568
SITE NAME:	KNOXVILLE ZOO
SITE NUMBER:	295226
SITE ADDRESS:	4105 HOLSTON DRIVE KNOXVILLE, TN 37914
DESIGN TYPE:	RAWLAND

SHEET TITLE:	LANDSCAPE PLAN
--------------	----------------

DRAWING NO.	REVISION:
L1	2

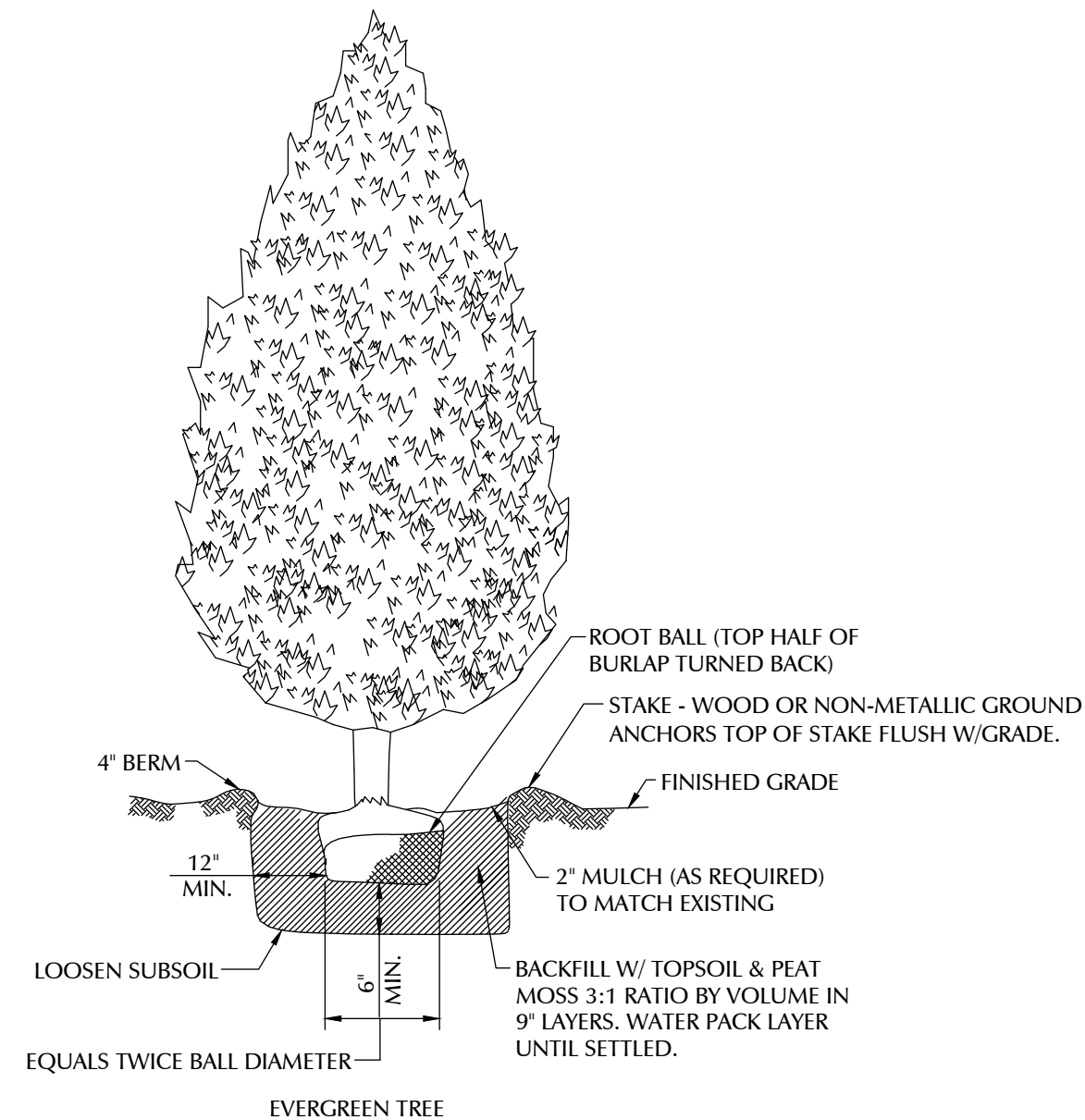

- NOTES:
1. EVERGREEN TREE SHALL BE MIN. 5'-0" IN HEIGHT AT TIME OF PLANTING.

9-B-16-UR  
Revised: 11/21/2016

LESSEE



1961 NORTHPOINT BLVD, SUITE 130  
HIXSON, TN 37343  
PH: 423-843-9500  
FAX: 423-843-9509

THE INFORMATION CONTAINED IN THIS SET OF DOCUMENTS IS PROPRIETARY BY NATURE. ANY USE OR DISCLOSURE OTHER THAN THAT WHICH RELATES TO THE CLIENT IS STRICTLY PROHIBITED.

A&E PROJECT #:	20141053568
DRAWN BY:	BNS
CHECKED BY:	CTD

REVISIONS		
Δ	11/18/16	ADD LANDSCP. & IRRIGATION
Δ	09/20/16	COMPOUND FENCE CHANGED
Δ	07/07/16	CONSTRUCTION ISSUE
Δ	06/14/16	PRELIMINARY REVIEW
NO.	DATE	DESCRIPTION

PROJECT No.	20141053568
SITE NAME:	KNOXVILLE ZOO
SITE NUMBER:	295226
SITE ADDRESS:	4105 HOLSTON DRIVE KNOXVILLE, TN 37914
DESIGN TYPE:	RAWLAND

SHEET TITLE:	LANDSCAPE DETAILS
--------------	-------------------

DRAWING NO.	REVISION:
L2	2

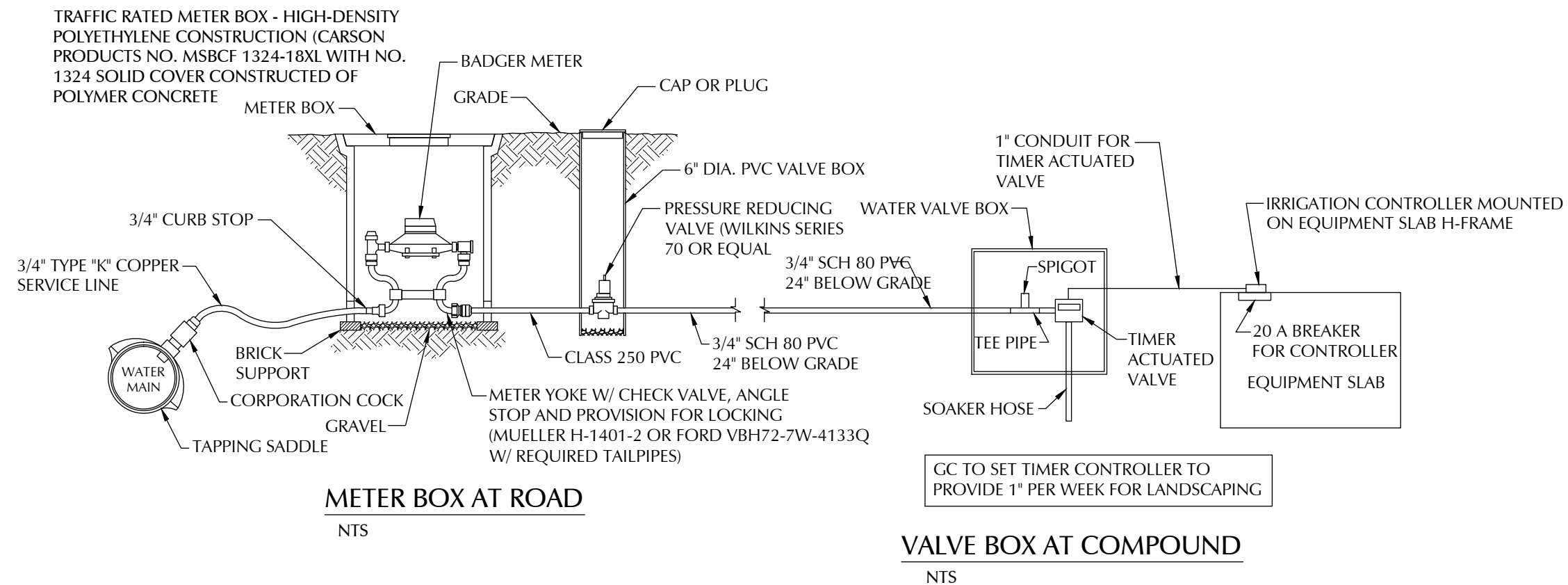

9-B-16-UR  
Revised: 11/21/2016

**LESSEE**

**TeleCAD Wireless**  
1961 NORTHPOINT BLVD, SUITE 130  
HIXSON, TN 37343  
PH: 423-843-9500  
FAX: 423-843-9509

THE INFORMATION CONTAINED IN THIS SET OF DOCUMENTS IS PROPRIETARY BY NATURE. ANY USE OR DISCLOSURE OTHER THAN THAT WHICH RELATES TO THE CLIENT IS STRICTLY PROHIBITED.

A&E PROJECT #:	20141053568
DRAWN BY:	BNS
CHECKED BY:	CTD

REVISIONS		
NO.	DATE	DESCRIPTION
1	11/18/16	ADD LANDSCP. & IRRIGATION
2	09/20/16	COMPOUND FENCE CHANGED
3	07/07/16	CONSTRUCTION ISSUE
4	06/14/16	PRELIMINARY REVIEW

PROJECT No.	20141053568
SITE NAME:	KNOXVILLE ZOO
SITE NUMBER:	295226
SITE ADDRESS:	4105 HOLSTON DRIVE KNOXVILLE, TN 37914
DESIGN TYPE:	RAWLAND

SHEET TITLE:	LANDSCAPE DETAILS
--------------	-------------------

DRAWING NO.	REVISION:
L3	2