

NOTE: SEE ARCHITECTURAL DRAWINGS FOR BUILDING WALL COLOR

DUMPSTER ENCLOSURE
N.T.S.

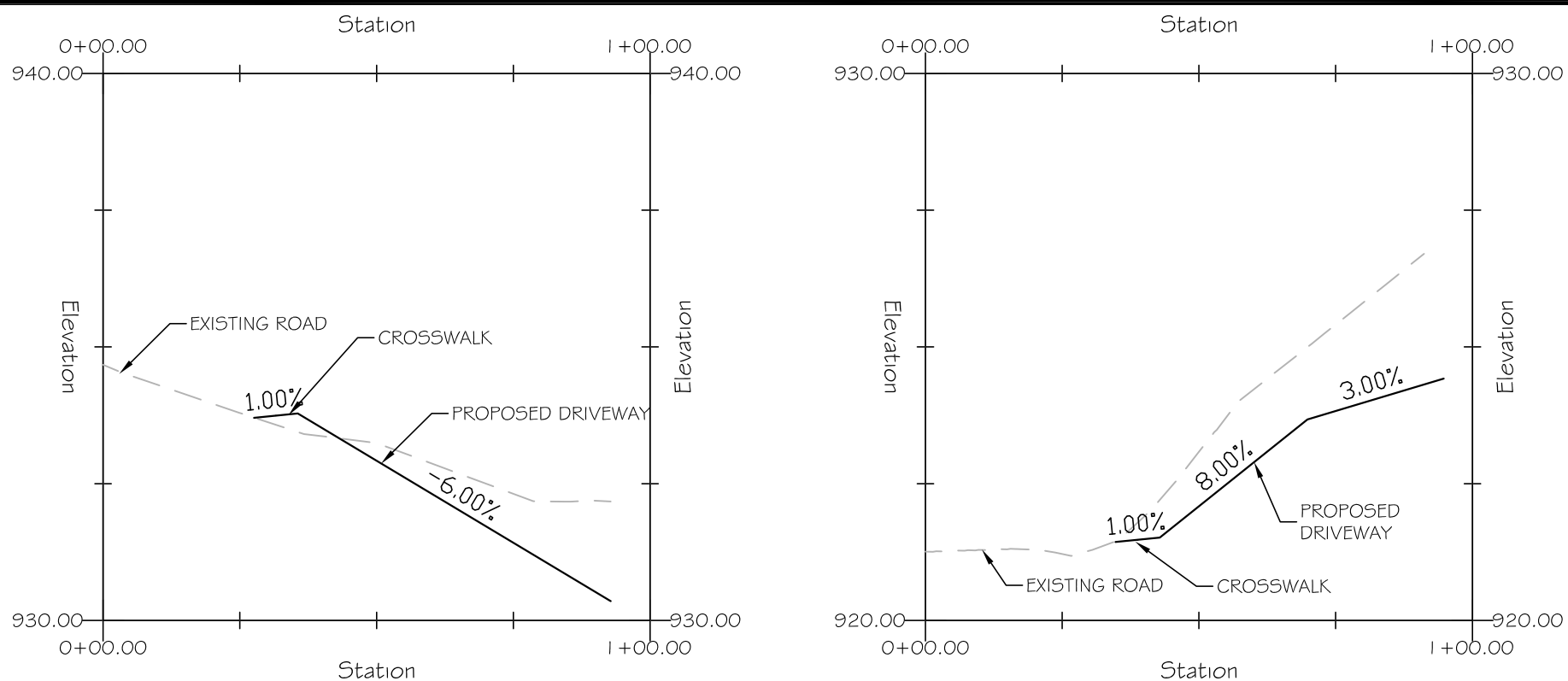

Profile View of Ailor Driveway
VERTICAL SCALE 1"=3'
HORIZONTAL SCALE 1"=30'

Profile View of 17th Street Driveway
VERTICAL SCALE 1"=3'
HORIZONTAL SCALE 1"=30'

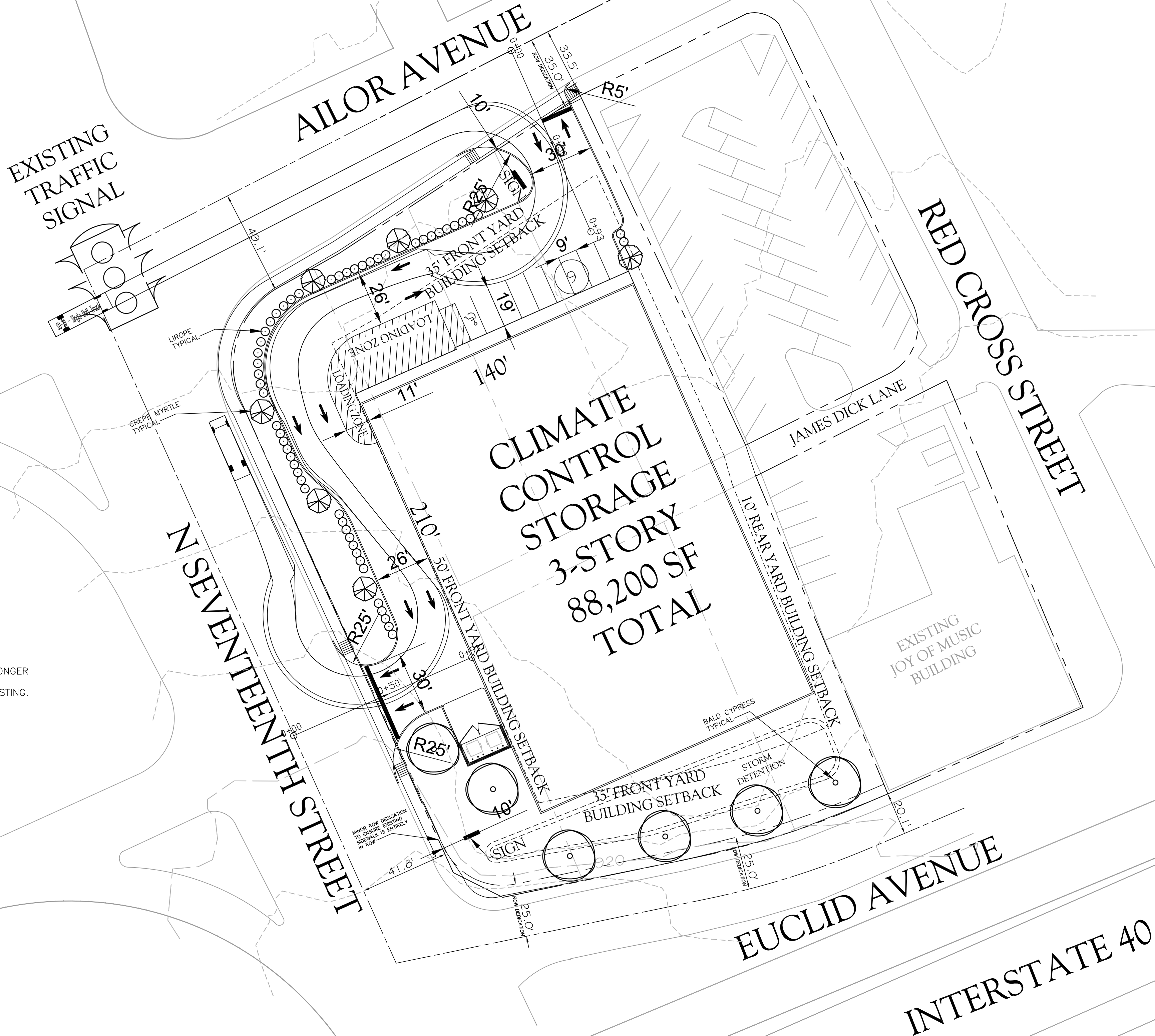
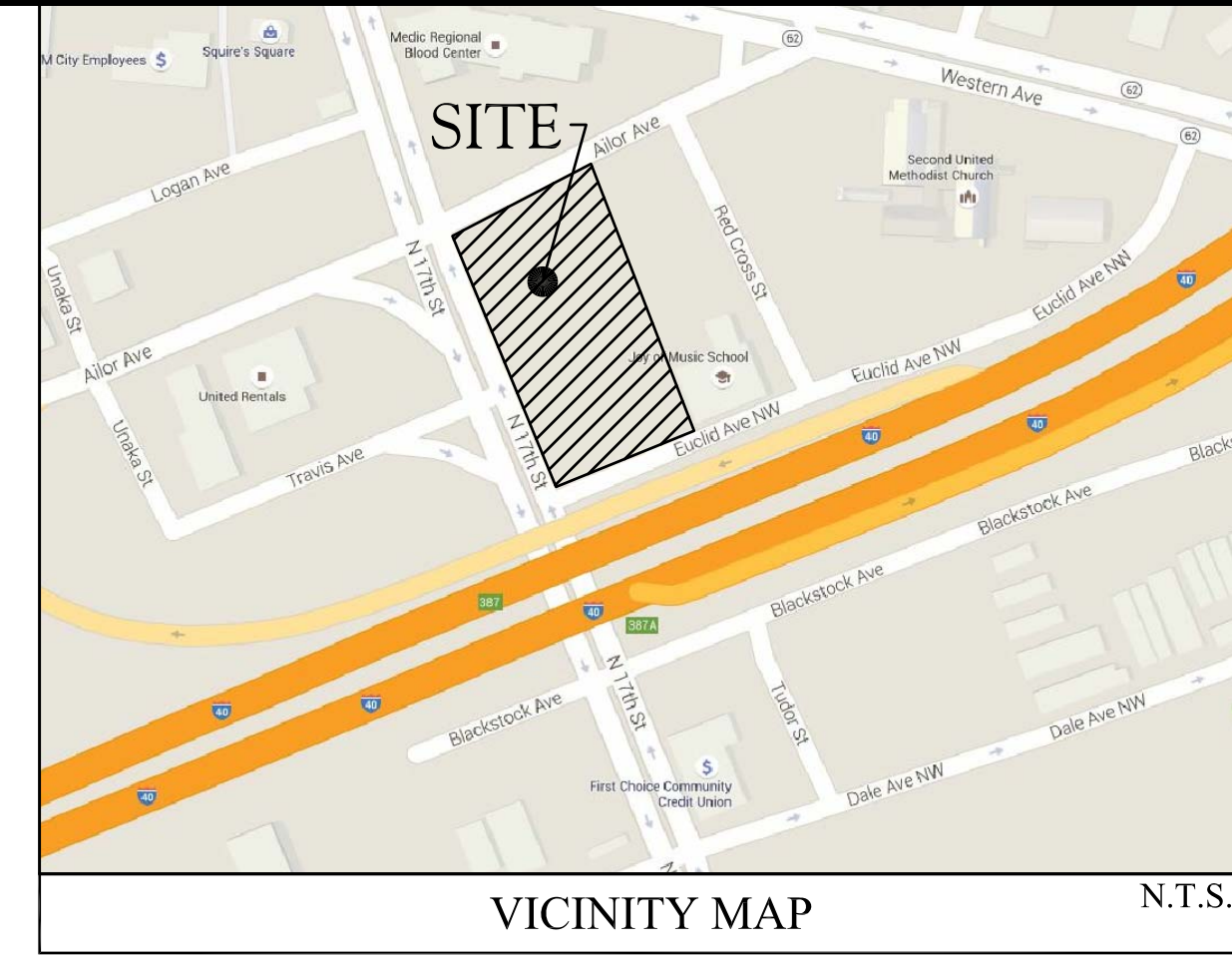

PROPERTY DATA:	
LOT AREA:	1.49 ACRES
ZONING:	C-4

PARKING REQUIRED: 1 PER EMPLOYEE PLUS 3 FOR CUSTOMERS = 6
PARKING PROVIDED: 9

ALL EXISTING CURB CUTS THAT ARE NO LONGER BEING UTILIZED ARE TO BE REMOVED AND SIDEWALKS RECONSTRUCTED TO MATCH EXISTING.

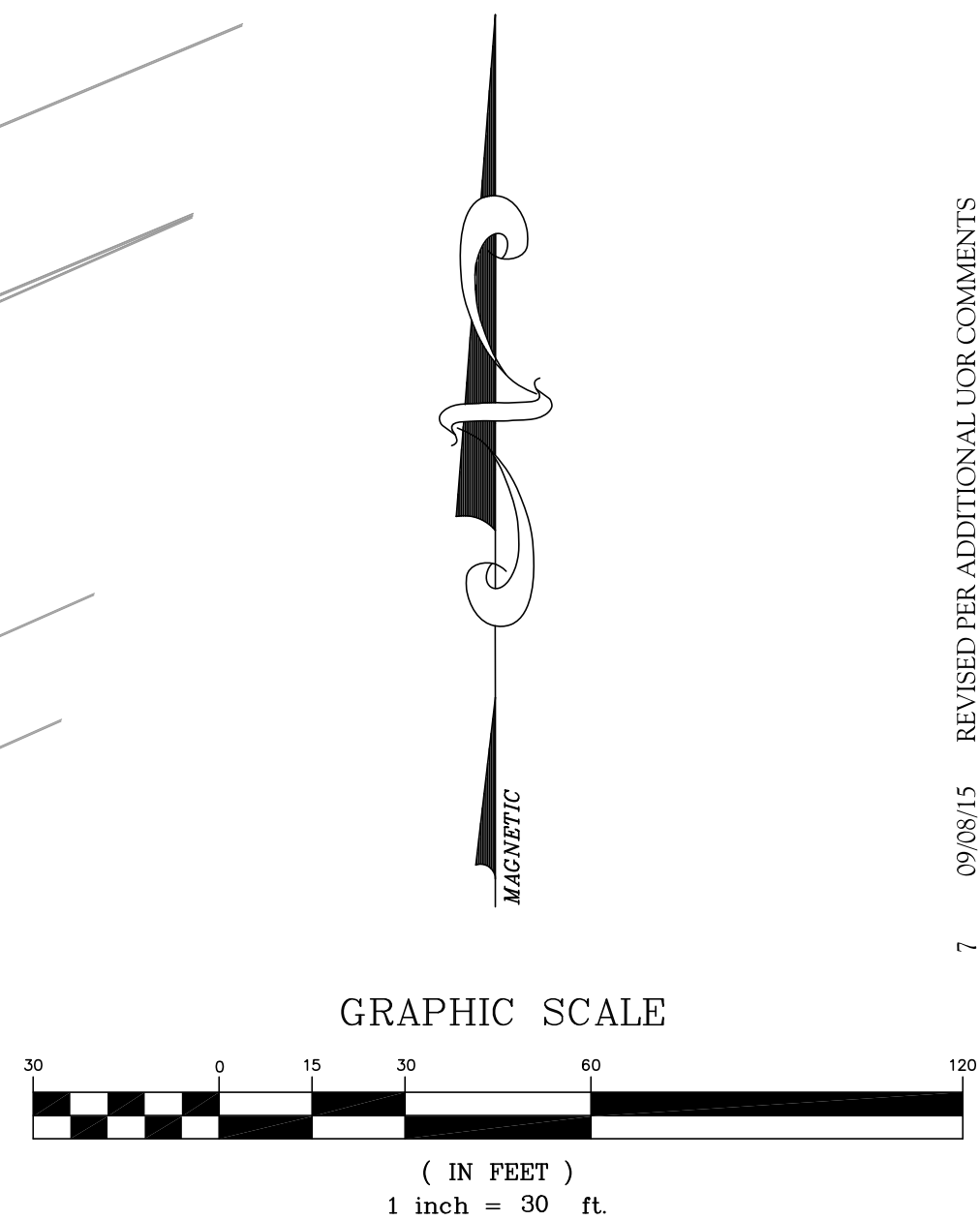

7	09/08/15	REVISED PER ADDITIONAL UOR COMMENTS
<hr/>		
DR-1	WV BY: <u>RWE</u>	DATE: <u>07/21/15</u>
<hr/>		
CHECKED BY: <u>JRA</u>	FILE: <u>1069</u>	
<hr/>		
REVISIONS		
NO.	DATE	COMMENTS
1	08/20/15	REVISED PER BLDG SETBACK CHANGES
2	08/26/15	REVISED PER UOR COMMENTS
3	08/31/15	REVISED PER ADDITIONAL UOR COMMENTS
4	09/01/15	REVISED PER ADDITIONAL UOR COMMENTS
5	09/02/15	REVISED PER ADDITIONAL UOR COMMENTS
6	09/03/15	REVISED PER ADDITIONAL UOR COMMENTS

Use on Review - Site Plan

Climate Control Storage

17th Street between Ailor Avenue and Euclid Avenue
Knoxville, Tennessee 37921

CSP-1

STEE
INCORPORATED
Civil Engineers & Surveyors

10215 Technology Drive, Suite 304
Knoxville, TN 37932
Phone: (865) 777-4160
Fax: (865) 777-4189

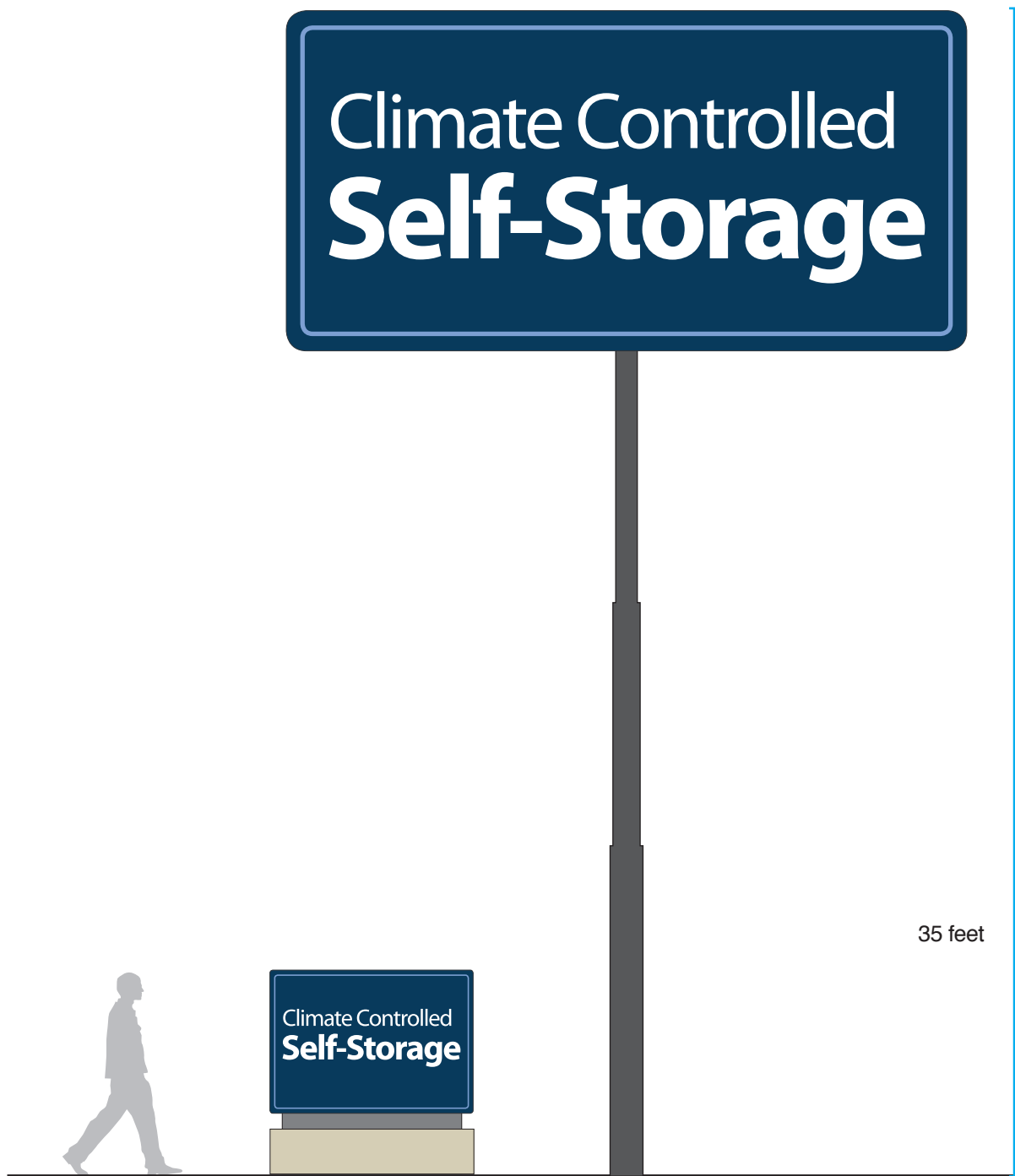

C: Ground Mounted Monument Sign: 6 x 6

B: PoleSign: 10 x 20

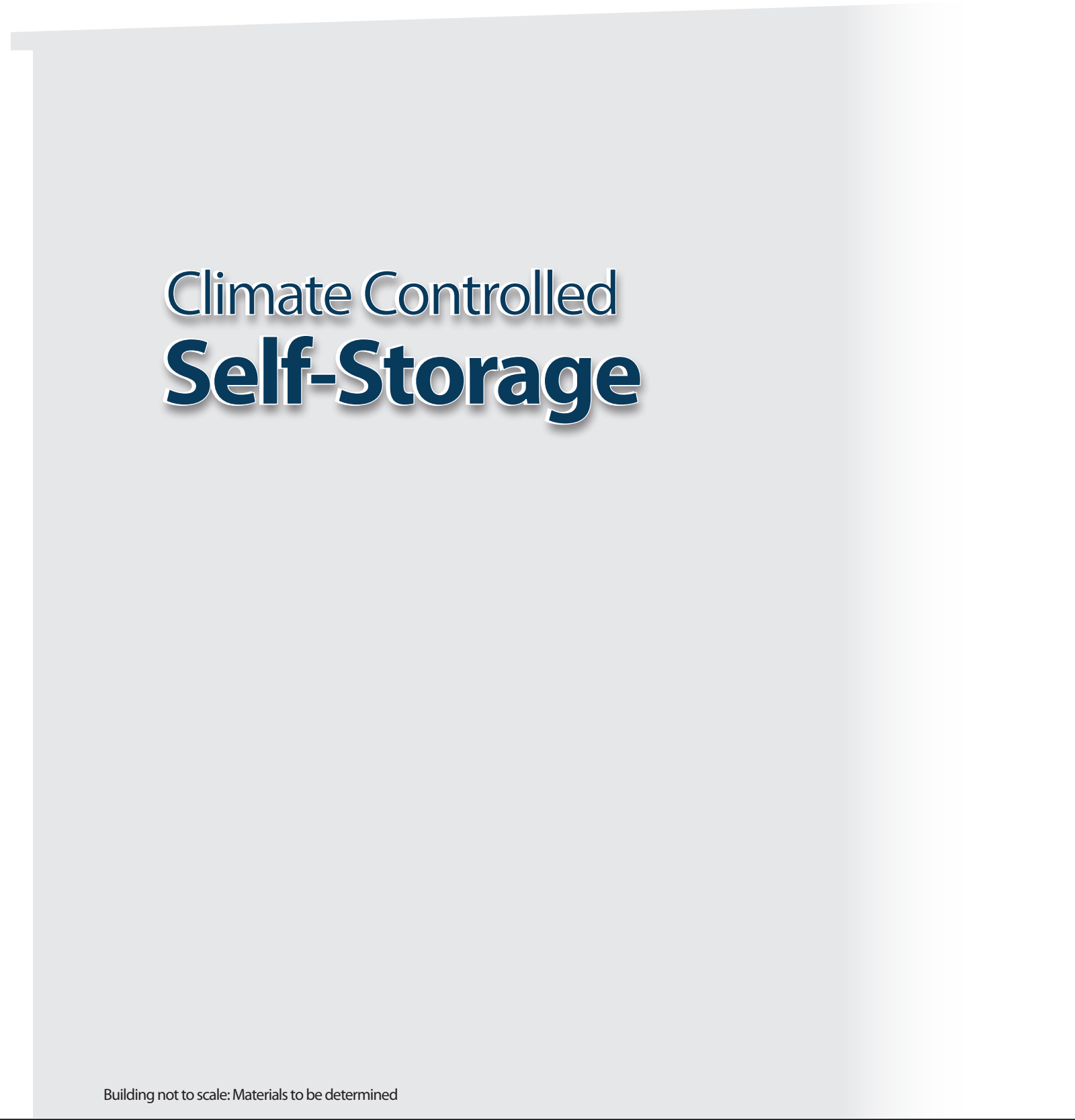

A: Building Mounted Signage: 11 x 20